



60 Hz
n ≈ 3450 rpm



Construction

Submersible borehole pumps for 6" wells (DN 150 mm) and 8" (DN 200 mm).

SX6, SX8: with external jacket and stages in stainless steel AISI 304.

SX6..N, SX8..N: with external jacket and stages in stainless steel AISI 316.

Impellers

| | |
|------------------|-------------------------|
| Radial impellers | Mixed flow impellers |
| SX6 13-18-27 | SX6 30-46-65, SX8 78-97 |

Connection: Screwed connection ISO 228
Delivery casing with built-in non-return valve.

Performance

Capacity up to 150 m³/h. Head up to 650 m.
Rated motor power output up to 110 kW.
Rotation speed 3450 r.p.m. (motor frequency 60 Hz).

Applications

For clean water, non-aggressive. For water supply. For irrigation.
For civil and industrial applications. For fire fighting applications.

Operating conditions

Liquid temperature up to a 25 °C.
Max. sand quantity into the water: 100 g/m³.
Continuous duty.

Materials

| Components | SX6 | SX6 (N) | SX8 | SX8 (N) |
|-----------------|-----------------------------|----------------|-------------------------|----------------|
| External jacket | Cr-Ni steel | Cr-Ni-Mo steel | Cr-Ni steel | Cr-Ni-Mo steel |
| Suction lantern | AISI 304 | AISI 316L | AISI 304 | AISI 316 |
| Upper cover | Cr-Ni-Mo steel AISI 316 | | | |
| Delivery casing | AISI 316L | | AISI 304 | AISI 316 |
| Strainer | Cr-Ni-Mo steel | | Cr-Ni-Mo steel | |
| Valve set | AISI 316 | | AISI 316 | |
| O-ring valve | NBR | | | |
| Shaft | Cr-Ni-Mo steel AISI 316 | | Cr-Ni-Mo steel AISI 329 | |
| Coupling set | Cr-Ni-Mo steel AISI 316/329 | | | |
| Diffuser | Cr-Ni steel | Cr-Ni-Mo steel | Cr-Ni steel | Cr-Ni-Mo steel |
| Stage casing | AISI 304 | AISI 316L | AISI 304 | AISI 316 |
| Impeller | AISI 304 | AISI 316L | AISI 316 | |
| Wear ring | Teflon (PTFE) | | | |
| Bearing bush | NBR | | | |
| Cable guard | Cr-Ni-Mo steel | | | |
| Screws | AISI 316 | | | |

Special features on request

- Other voltages. - 60 Hz frequency.

Coverage chart

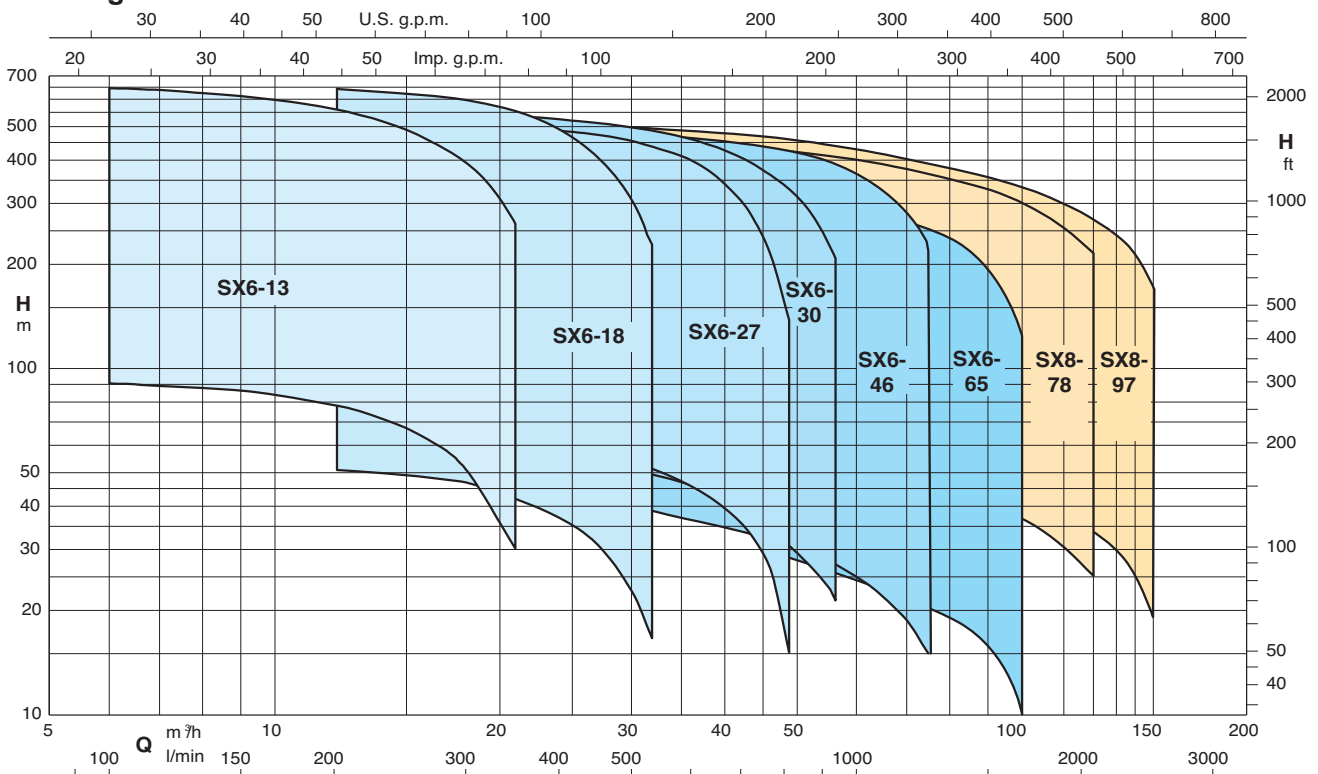

Tolerances according to ISO 9906-A

72.1161-60Hz

SX6-13

6" SUBMERSIBLE PUMPS

60 Hz - n ≈ 3450 rpm

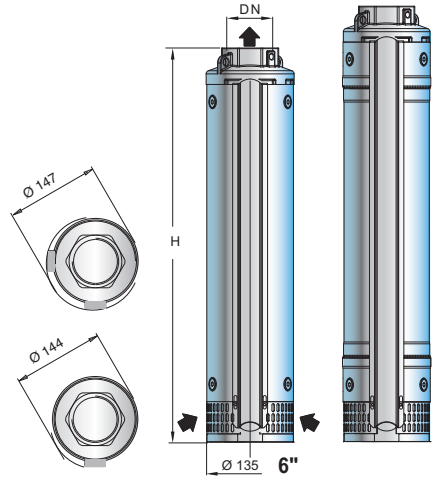
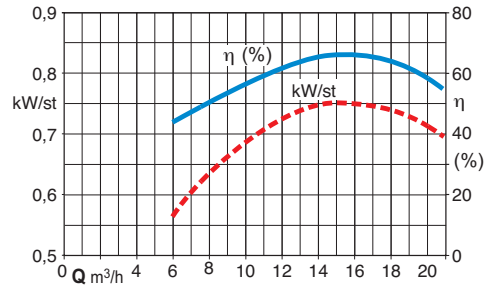
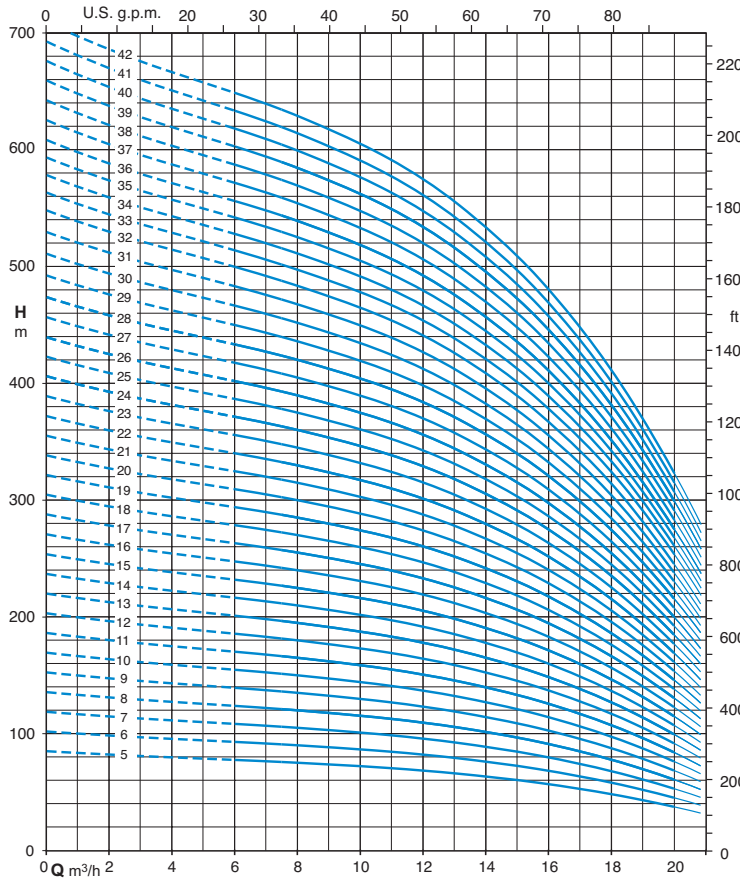

| TYPE | MOTOR | | Q m³/h l/min | DELIVERY | | | | | | | | | | |
|---------------|-------|------|--------------------|----------|-----|------|------|------|------|------|------|----|--|--|
| | kW | HP | | H m HEAD | | | | | | | | | | |
| | | | | 0 | 6 | 8 | 10 | 12 | 14 | 16 | 18 | 21 | | |
| SX6-13/5 (N) | 4 | 5,5 | 85 | 78 | 75 | 72 | 69 | 63,3 | 56,5 | 47,5 | 30 | | | |
| SX6-13/6 (N) | 5,5 | 7,5 | 102 | 92,5 | 90 | 86,5 | 82,5 | 76,5 | 67,5 | 58,5 | 37,5 | | | |
| SX6-13/7 (N) | 5,5 | 7,5 | 118 | 108 | 105 | 101 | 96,5 | 89,5 | 79 | 68,5 | 44 | | | |
| SX6-13/8 (N) | 5,5 | 7,5 | 135 | 123 | 120 | 115 | 110 | 102 | 90 | 78 | 50 | | | |
| SX6-13/9 (N) | 7,5 | 10 | 153 | 139 | 135 | 130 | 123 | 114 | 103 | 88 | 58 | | | |
| SX6-13/10 (N) | 7,5 | 10 | 170 | 154 | 150 | 144 | 137 | 127 | 115 | 97,5 | 64,5 | | | |
| SX6-13/11 (N) | 7,5 | 10 | 185 | 170 | 165 | 159 | 150 | 140 | 125 | 108 | 70 | | | |
| SX6-13/12 (N) | 9,3 | 12,5 | 204 | 185 | 180 | 173 | 164 | 152 | 138 | 117 | 77,5 | | | |
| SX6-13/13 (N) | 9,3 | 12,5 | 220 | 200 | 195 | 188 | 178 | 165 | 149 | 127 | 85 | | | |
| SX6-13/14 (N) | 11 | 15 | 237 | 216 | 210 | 202 | 191 | 177 | 161 | 137 | 90,5 | | | |
| SX6-13/15 (N) | 11 | 15 | 254 | 232 | 224 | 216 | 205 | 190 | 170 | 147 | 96 | | | |
| SX6-13/16 (N) | 11 | 15 | 271 | 247 | 240 | 231 | 219 | 203 | 184 | 156 | 104 | | | |
| SX6-13/17 (N) | 13 | 17,5 | 288 | 262 | 255 | 245 | 232 | 215 | 195 | 166 | 110 | | | |
| SX6-13/18 (N) | 15 | 20 | 304 | 278 | 270 | 260 | 246 | 228 | 206 | 177 | 117 | | | |
| SX6-13/19 (N) | 15 | 20 | 321 | 294 | 285 | 275 | 260 | 240 | 217 | 169 | 124 | | | |
| SX6-13/20 (N) | 15 | 20 | 337 | 309 | 300 | 288 | 274 | 254 | 229 | 197 | 130 | | | |
| SX6-13/21 (N) | 15 | 20 | 354 | 324 | 315 | 303 | 288 | 267 | 240 | 207 | 137 | | | |
| SX6-13/22 (N) | 15 | 20 | 371 | 340 | 330 | 317 | 300 | 280 | 250 | 215 | 142 | | | |
| SX6-13/23 (N) | 18,5 | 25 | 388 | 355 | 345 | 332 | 315 | 292 | 263 | 226 | 150 | | | |
| SX6-13/24 (N) | 18,5 | 25 | 405 | 370 | 360 | 345 | 329 | 305 | 274 | 235 | 156 | | | |
| SX6-13/25 (N) | 18,5 | 25 | 422 | 386 | 375 | 361 | 342 | 317 | 286 | 246 | 163 | | | |
| SX6-13/26 (N) | 18,5 | 25 | 440 | 400 | 390 | 375 | 355 | 330 | 297 | 254 | 169 | | | |
| SX6-13/27 (N) | 18,5 | 25 | 455 | 417 | 405 | 389 | 370 | 343 | 309 | 265 | 176 | | | |
| SX6-13/28 (N) | 18,5 | 25 | 472 | 432 | 420 | 404 | 383 | 355 | 320 | 275 | 182 | | | |
| SX6-13/29 (N) | 22 | 30 | 489 | 448 | 435 | 418 | 397 | 368 | 332 | 285 | 189 | | | |
| SX6-13/30 (N) | 22 | 30 | 506 | 463 | 450 | 433 | 411 | 381 | 343 | 295 | 195 | | | |
| SX6-13/31 (N) | 22 | 30 | 523 | 479 | 465 | 447 | 424 | 393 | 355 | 305 | 202 | | | |
| SX6-13/32 (N) | 22 | 30 | 540 | 494 | 480 | 461 | 438 | 406 | 366 | 315 | 208 | | | |
| SX6-13/33 (N) | 26 | 35 | 557 | 509 | 495 | 476 | 452 | 419 | 377 | 324 | 215 | | | |
| SX6-13/34 (N) | 26 | 35 | 573 | 525 | 510 | 490 | 465 | 431 | 389 | 334 | 221 | | | |
| SX6-13/35 (N) | 26 | 35 | 590 | 540 | 525 | 505 | 479 | 444 | 400 | 344 | 228 | | | |
| SX6-13/36 (N) | 26 | 35 | 607 | 556 | 540 | 519 | 493 | 457 | 412 | 354 | 234 | | | |
| SX6-13/37 (N) | 30 | 40 | 624 | 571 | 555 | 533 | 506 | 469 | 423 | 364 | 241 | | | |
| SX6-13/38 (N) | 30 | 40 | 641 | 587 | 570 | 548 | 520 | 482 | 435 | 373 | 247 | | | |
| SX6-13/39 (N) | 30 | 40 | 658 | 602 | 585 | 562 | 534 | 495 | 446 | 383 | 254 | | | |
| SX6-13/40 (N) | 30 | 40 | 675 | 617 | 600 | 577 | 547 | 507 | 457 | 393 | 260 | | | |
| SX6-13/41 (N) | 30 | 40 | 691 | 633 | 615 | 591 | 561 | 520 | 469 | 403 | 267 | | | |
| SX6-13/42 (N) | 30 | 40 | 708 | 648 | 630 | 606 | 575 | 533 | 480 | 413 | 273 | | | |

| DN | MOTOR | H mm | kg |
|-------------|-------|---------|------|
| Rp 2"1/2 | 6" | 411 | 11,5 |
| | | 441 | 12,3 |
| | | 471 | 13 |
| | | 501 | 14 |
| | | 531 | 14,5 |
| | | 561 | 15 |
| | | 591 | 16 |
| | | 621 | 16,8 |
| | | 651 | 17,5 |
| | | 681 | 18,5 |
| | | 711 | 19 |
| | | 741 | 19,8 |
| | | 771 | 20,5 |
| | | 801 | 21,3 |
| | | 831 | 22 |
| | | 861 | 23 |
| | | 891 | 23,5 |
| | | 921 | 24 |
| | | 951 | 25 |
| | | 981 | 25,5 |
| | | 1011 | 26,5 |
| 1041 | 27 | | |
| 1071 | 29 | | |
| 1101 | 29 | | |
| 1131 | 30,5 | | |
| 1161 | 30,8 | | |
| 1191 | 31 | | |
| 1221 | 31,5 | | |
| 1251 | 32,5 | | |
| 1281 | 33,5 | | |
| 1311 | 34 | | |
| 1341 | 34,5 | | |
| 1371 | 35,3 | | |
| 1401 | 36 | | |
| 1431 | 37,3 | | |
| 1461 | 38,5 | | |
| 1491 | 38,8 | | |
| 1521 | 39 | | |

The encumbered dimensions and weight are indicative.

SX6-18

6" SUBMERSIBLE PUMPS

60 Hz - n ≈ 3450 rpm

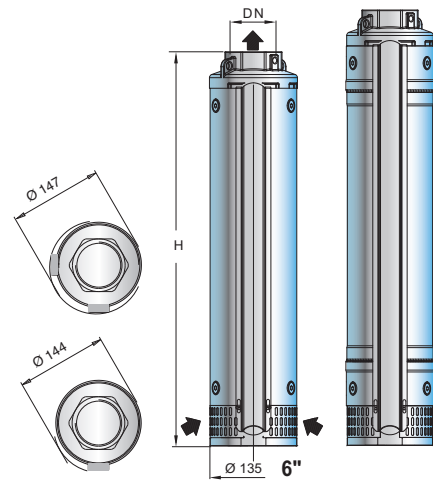
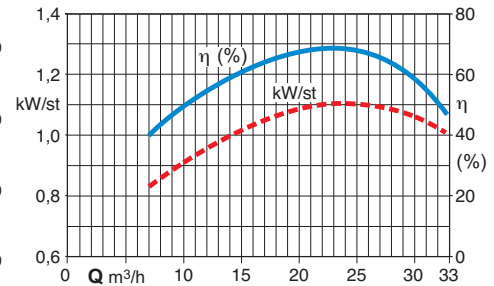
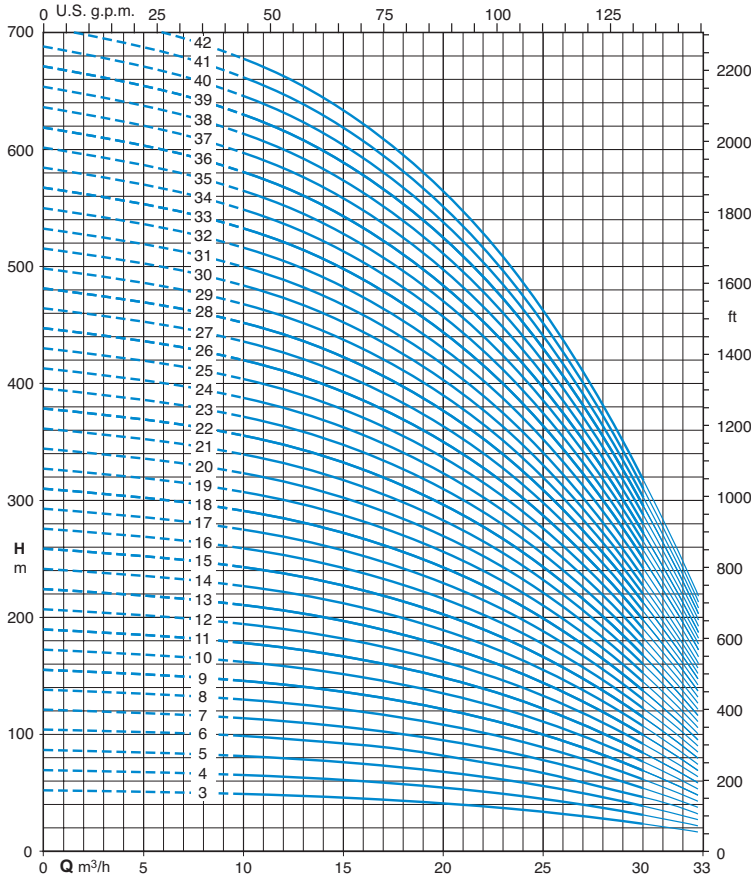

| TYPE | MOTOR | | Q m³/h l/min | DELIVERY | | | | | | | | |
|---------------|-------|------|--------------------|----------|------|------|------|-----|------|------|------|------|
| | kW | HP | | 0 | 12 | 15 | 18 | 21 | 24 | 27 | 30 | 32 |
| SX6-18/3 (N) | 4 | 5,5 | H m HEAD | 51 | 46,5 | 45 | 42 | 38 | 34 | 29 | 22 | 16,5 |
| SX6-18/4 (N) | 5,5 | 7,5 | | 68 | 63,5 | 60 | 56 | 52 | 46,5 | 39 | 30,5 | 23 |
| SX6-18/5 (N) | 5,5 | 7,5 | | 85 | 79,5 | 75 | 70 | 65 | 58 | 49 | 38 | 29 |
| SX6-18/6 (N) | 7,5 | 10 | | 102 | 95 | 91,5 | 85,5 | 78 | 69,5 | 59 | 45,5 | 35,5 |
| SX6-18/7 (N) | 7,5 | 10 | | 120 | 110 | 106 | 100 | 90 | 80 | 69 | 52 | 40 |
| SX6-18/8 (N) | 9,3 | 12,5 | | 136 | 127 | 122 | 114 | 104 | 93 | 79 | 60,5 | 47,5 |
| SX6-18/9 (N) | 9,3 | 12,5 | | 154 | 141 | 135 | 128 | 117 | 104 | 87 | 68 | 52,5 |
| SX6-18/10 (N) | 11 | 15 | | 170 | 159 | 153 | 143 | 130 | 116 | 98,5 | 75,5 | 59,5 |
| SX6-18/11 (N) | 11 | 15 | | 190 | 174 | 165 | 156 | 144 | 128 | 108 | 83,5 | 65 |
| SX6-18/12 (N) | 15 | 20 | | 203 | 191 | 183 | 171 | 156 | 139 | 119 | 91 | 71 |
| SX6-18/13 (N) | 15 | 20 | | 224 | 205 | 197 | 185 | 170 | 150 | 127 | 99 | 76,5 |
| SX6-18/14 (N) | 15 | 20 | | 237 | 222 | 214 | 200 | 182 | 163 | 138 | 106 | 83 |
| SX6-18/15 (N) | 15 | 20 | | 254 | 238 | 229 | 214 | 195 | 174 | 148 | 114 | 89 |
| SX6-18/16 (N) | 18,5 | 25 | | 275 | 253 | 242 | 228 | 209 | 186 | 157 | 121 | 95 |
| SX6-18/17 (N) | 18,5 | 25 | | 292 | 269 | 257 | 242 | 222 | 198 | 166 | 128 | 101 |
| SX6-18/18 (N) | 18,5 | 25 | | 310 | 284 | 270 | 256 | 235 | 210 | 175 | 137 | 106 |
| SX6-18/19 (N) | 22 | 30 | | 327 | 300 | 288 | 270 | 248 | 221 | 186 | 143 | 113 |
| SX6-18/20 (N) | 22 | 30 | | 344 | 316 | 303 | 285 | 261 | 232 | 196 | 151 | 119 |
| SX6-18/21 (N) | 22 | 30 | | 361 | 332 | 318 | 299 | 274 | 244 | 205 | 159 | 125 |
| SX6-18/22 (N) | 22 | 30 | | 379 | 348 | 331 | 312 | 287 | 255 | 215 | 165 | 130 |
| SX6-18/23 (N) | 26 | 35 | | 395 | 363 | 348 | 327 | 300 | 267 | 225 | 174 | 137 |
| SX6-18/24 (N) | 26 | 35 | | 413 | 379 | 363 | 341 | 313 | 279 | 235 | 181 | 143 |
| SX6-18/25 (N) | 30 | 40 | | 430 | 395 | 378 | 356 | 326 | 290 | 244 | 189 | 148 |
| SX6-18/26 (N) | 30 | 40 | | 448 | 410 | 394 | 370 | 339 | 300 | 255 | 197 | 153 |
| SX6-18/27 (N) | 30 | 40 | | 464 | 426 | 409 | 384 | 352 | 314 | 264 | 204 | 160 |
| SX6-18/28 (N) | 30 | 40 | | 481 | 442 | 424 | 398 | 365 | 325 | 274 | 211 | 166 |
| SX6-18/29 (N) | 30 | 40 | | 498 | 458 | 439 | 412 | 378 | 337 | 284 | 219 | 172 |
| SX6-18/30 (N) | 30 | 40 | | 516 | 474 | 454 | 427 | 391 | 348 | 293 | 226 | 178 |
| SX6-18/31 (N) | (37) | (50) | | 533 | 490 | 469 | 441 | 404 | 360 | 303 | 234 | 184 |
| SX6-18/32 (N) | (37) | (50) | | 550 | 505 | 484 | 455 | 417 | 372 | 313 | 241 | 190 |
| SX6-18/33 (N) | (37) | (50) | | 567 | 521 | 499 | 469 | 430 | 383 | 323 | 249 | 196 |
| SX6-18/34 (N) | (37) | (50) | | 584 | 537 | 515 | 484 | 443 | 395 | 332 | 256 | 202 |
| SX6-18/35 (N) | (37) | (50) | | 602 | 553 | 530 | 498 | 457 | 407 | 342 | 264 | 208 |
| SX6-18/36 (N) | (37) | (50) | | 619 | 569 | 545 | 512 | 470 | 418 | 352 | 272 | 214 |
| SX6-18/37 (N) | (45) | (60) | | 636 | 584 | 560 | 526 | 483 | 430 | 362 | 279 | 220 |
| SX6-18/38 (N) | (45) | (60) | | 653 | 600 | 575 | 540 | 496 | 441 | 371 | 287 | 226 |
| SX6-18/39 (N) | (45) | (60) | | 670 | 616 | 590 | 555 | 509 | 453 | 381 | 294 | 231 |
| SX6-18/40 (N) | (45) | (60) | | 687 | 632 | 605 | 569 | 522 | 465 | 391 | 302 | 237 |
| SX6-18/41 (N) | (45) | (60) | | 705 | 647 | 620 | 583 | 535 | 476 | 401 | 309 | 243 |
| SX6-18/42 (N) | (45) | (60) | | 722 | 663 | 636 | 597 | 548 | 488 | 411 | 317 | 249 |

| DN | MOTOR | H mm | kg |
|-------------|-------|---------|------|
| Rp 2"1/2 | 6" | 383 | 10,5 |
| | | 420 | 11 |
| | | 458 | 11,5 |
| | | 494 | 12,5 |
| | | 532 | 13,5 |
| | | 569 | 14,3 |
| | | 607 | 15 |
| | | 644 | 16 |
| | | 682 | 17 |
| | | 719 | 17,5 |
| | | 757 | 18,5 |
| | | 794 | 19,3 |
| | | 832 | 20 |
| | | 869 | 21 |
| | | 907 | 22 |
| | | 944 | 22,5 |
| | | 982 | 23,5 |
| | | 1019 | 24 |
| | | 1057 | 25 |
| | | 1094 | 26 |
| 1132 | 26,5 | | |
| 1169 | 27,5 | | |
| 1207 | 28,3 | | |
| 1244 | 29 | | |
| 1282 | 31 | | |
| 1319 | 31 | | |
| 1356 | 31,5 | | |
| 1394 | 32,5 | | |
| 1431 | 33,3 | | |
| 1469 | 34 | | |
| 1506 | 35 | | |
| 1544 | 35,7 | | |
| 1581 | 36,3 | | |
| 1619 | 37 | | |
| 1656 | 38,4 | | |
| 1694 | 39,8 | | |
| 1731 | 40 | | |
| 1769 | 40,5 | | |
| 1806 | 41,8 | | |
| 1844 | 43 | | |

The encumbered dimensions and weight are indicative.

SX6-27

6" SUBMERSIBLE PUMPS

60 Hz - $n \approx 3450$ rpm

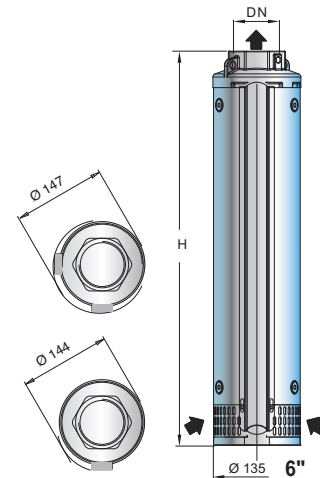
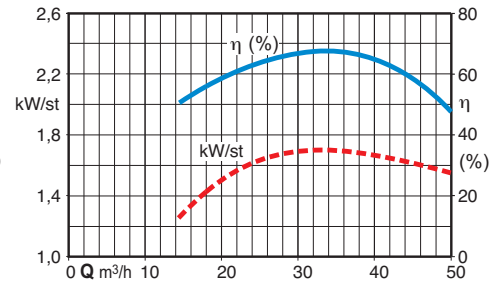
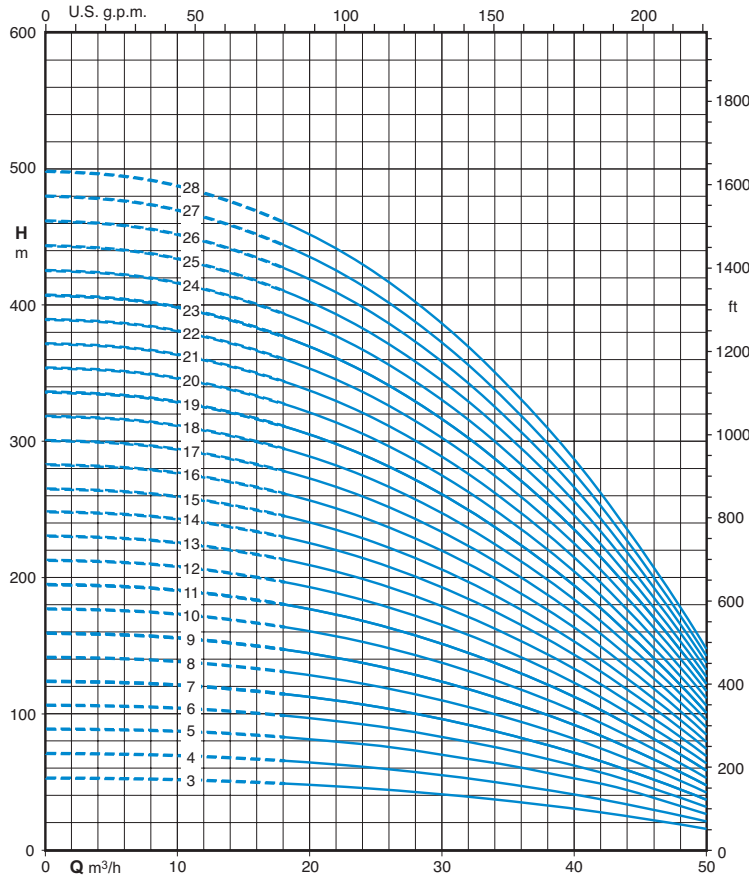

| TYPE | MOTOR | | Q m³/h l/min | DELIVERY | | | | | | | | | | | | |
|---------------|-------|------|--------------------|----------|------|-----|------|------|------|-----|------|-------|--|--|--|--|
| | kW | HP | | 0 | 16 | 20 | 24 | 28 | 32 | 40 | 45 | 50 | | | | |
| SX6-27/3 (N) | 5,5 | 7,5 | H m HEAD | 52 | 50 | 49 | 46,5 | 42 | 39,5 | 30 | 25 | 15 | | | | |
| SX6-27/4 (N) | 7,5 | 10 | | 71 | 68 | 65 | 61,5 | 54 | 52 | 40 | 31 | 21,5 | | | | |
| SX6-27/5 (N) | 11 | 15 | | 89,5 | 83,5 | 80 | 77 | 71,5 | 66 | 50 | 39,5 | 25,5 | | | | |
| SX6-27/6 (N) | 11 | 15 | | 107 | 101 | 96 | 92,5 | 85,5 | 79,5 | 60 | 47 | 31 | | | | |
| SX6-27/7 (N) | 11 | 15 | | 125 | 117 | 112 | 108 | 100 | 92,5 | 70 | 55 | 36 | | | | |
| SX6-27/8 (N) | 15 | 20 | | 143 | 135 | 130 | 123 | 115 | 106 | 81 | 63 | 43 | | | | |
| SX6-27/9 (N) | 15 | 20 | | 160 | 150 | 145 | 139 | 130 | 120 | 91 | 71 | 49 | | | | |
| SX6-27/10 (N) | 18,5 | 25 | | 178 | 168 | 162 | 154 | 143 | 132 | 102 | 79 | 53,5 | | | | |
| SX6-27/11 (N) | 18,5 | 25 | | 195 | 185 | 179 | 169 | 159 | 145 | 112 | 87 | 60 | | | | |
| SX6-27/12 (N) | 22 | 30 | | 214 | 202 | 195 | 185 | 172 | 159 | 122 | 95 | 64,5 | | | | |
| SX6-27/13 (N) | 22 | 30 | | 232 | 218 | 211 | 200 | 186 | 172 | 132 | 102 | 69,5 | | | | |
| SX6-27/14 (N) | 22 | 30 | | 250 | 235 | 227 | 215 | 200 | 185 | 142 | 110 | 75 | | | | |
| SX6-27/15 (N) | 26 | 35 | | 266 | 250 | 240 | 230 | 215 | 198 | 154 | 120 | 80 | | | | |
| SX6-27/16 (N) | 30 | 40 | | 285 | 268 | 258 | 244 | 230 | 211 | 164 | 125 | 83,5 | | | | |
| SX6-27/17 (N) | 30 | 40 | | 303 | 285 | 274 | 259 | 244 | 224 | 174 | 133 | 88,5 | | | | |
| SX6-27/18 (N) | 30 | 40 | | 320 | 302 | 290 | 274 | 259 | 237 | 184 | 141 | 94 | | | | |
| SX6-27/19 (N) | 30 | 40 | | 338 | 316 | 305 | 290 | 270 | 250 | 192 | 150 | 100 | | | | |
| SX6-27/20 (N) | (37) | (50) | | 356 | 335 | 322 | 305 | 287 | 264 | 205 | 157 | 104,5 | | | | |
| SX6-27/21 (N) | (37) | (50) | | 374 | 352 | 338 | 320 | 302 | 277 | 215 | 165 | 109,5 | | | | |
| SX6-27/22 (N) | (37) | (50) | | 391 | 369 | 354 | 335 | 316 | 290 | 225 | 172 | 115 | | | | |
| SX6-27/23 (N) | (37) | (50) | | 409 | 385 | 370 | 350 | 330 | 303 | 235 | 180 | 120 | | | | |
| SX6-27/24 (N) | (45) | (60) | | 427 | 402 | 386 | 365 | 345 | 316 | 245 | 188 | 125 | | | | |
| SX6-27/25 (N) | (45) | (60) | | 445 | 419 | 402 | 381 | 359 | 330 | 256 | 196 | 130,5 | | | | |
| SX6-27/26 (N) | (45) | (60) | | 463 | 435 | 419 | 396 | 373 | 343 | 266 | 204 | 135,5 | | | | |
| SX6-27/27 (N) | (45) | (60) | | 480 | 452 | 435 | 411 | 388 | 356 | 276 | 212 | 141 | | | | |
| SX6-27/28 (N) | (45) | (60) | | 498 | 469 | 451 | 426 | 402 | 369 | 286 | 219 | 146 | | | | |

| DN | MOTOR | H mm | kg |
|-------|-------|------|------|
| Rp 3" | 6" | 479 | 11,5 |
| | | 524 | 12,5 |
| | | 571 | 13,5 |
| | | 617 | 14,5 |
| | | 664 | 15,5 |
| | | 710 | 16,5 |
| | | 757 | 17,5 |
| | | 803 | 19 |
| | | 850 | 19,5 |
| | | 896 | 21 |
| | | 943 | 22,5 |
| | | 989 | 22,5 |
| | | 1036 | 23 |
| | | 1082 | 24,5 |
| | | 1129 | 25 |
| | | 1175 | 26 |
| 1222 | 27 | | |
| 1268 | 28 | | |
| 1315 | 29 | | |
| 1361 | 30 | | |
| 1408 | 31 | | |
| 1454 | 32 | | |
| 1500 | 33 | | |
| 1547 | 35 | | |
| 1593 | 35 | | |
| 1640 | 36 | | |

The encumbered dimensions and weight are indicative.

SX6-30

6" SUBMERSIBLE PUMPS

60 Hz - $n \approx 3450$ rpm

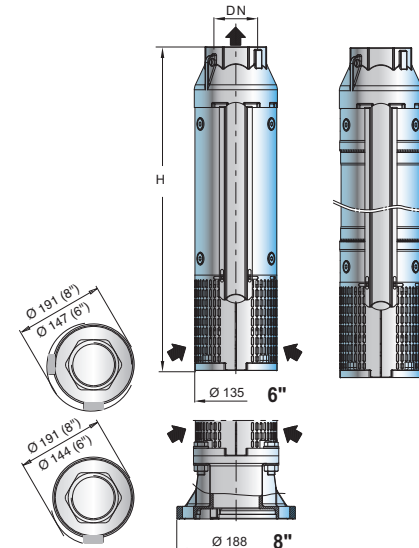
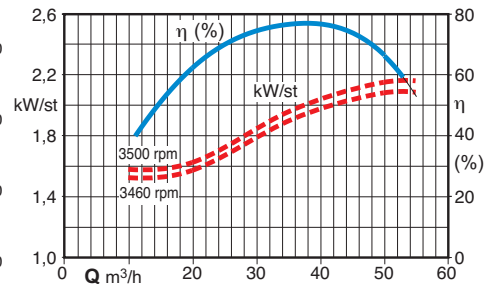
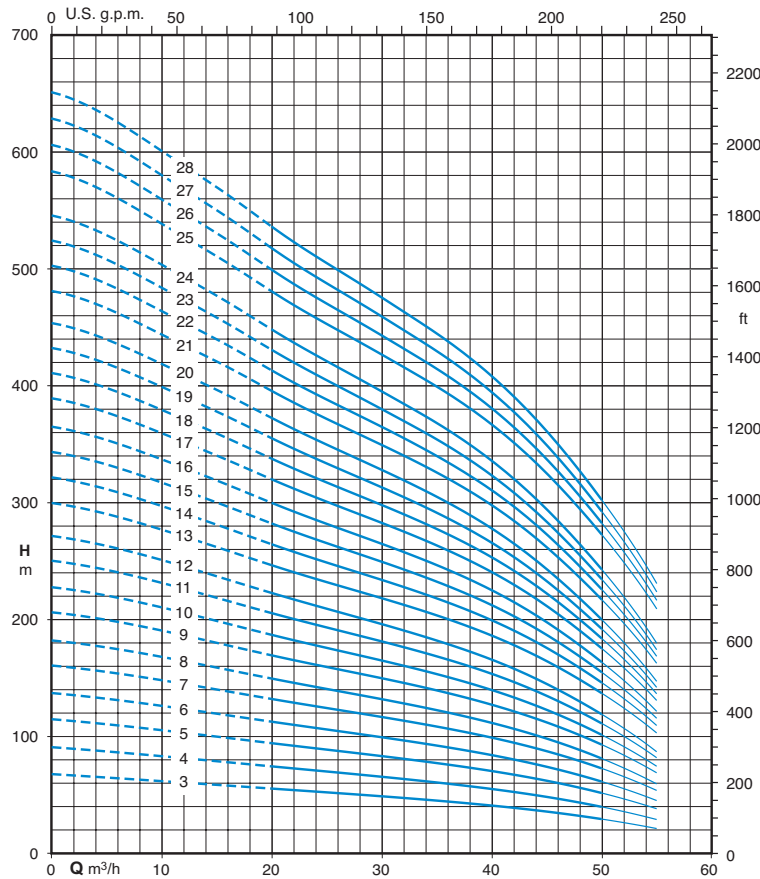

| TYPE | MOTOR | | Q m³/h l/min | DELIVERY | | | | | | | | | | | | | | | | | |
|---------------|-------|------|--------------------|----------|------|------|------|------|------|------|------|----|--|--|--|--|--|--|--|--|--|
| | kW | HP | | H m HEAD | | | | | | | | | | | | | | | | | |
| | | | | 0 | 20 | 25 | 30 | 35 | 40 | 45 | 50 | 55 | | | | | | | | | |
| SX6-30/3 (N) | 5,5 | 7,5 | 67,4 | 55,2 | 51,9 | 48,6 | 45,2 | 41,1 | 35,9 | 29,3 | 21,4 | | | | | | | | | | |
| SX6-30/4 (N) | 7,5 | 10 | 90,5 | 74,2 | 69,7 | 65,3 | 60,8 | 55,3 | 48,4 | 39,7 | 29,1 | | | | | | | | | | |
| SX6-30/5 (N) | 9,3 | 12,5 | 115 | 94 | 88,4 | 83 | 77,5 | 70,7 | 62,2 | 51,4 | 38,4 | | | | | | | | | | |
| SX6-30/6 (N) | 11 | 15 | 137 | 112 | 106 | 99,2 | 92,5 | 84,4 | 74,1 | 61,1 | 45,5 | | | | | | | | | | |
| SX6-30/7 (N) | 15 | 20 | 161 | 132 | 124 | 117 | 109 | 99,4 | 87,4 | 72,4 | 54,3 | | | | | | | | | | |
| SX6-30/8 (N) | 15 | 20 | 182 | 150 | 141 | 132 | 123 | 112 | 98,1 | 80,9 | 59,9 | | | | | | | | | | |
| SX6-30/9 (N) | 18,5 | 25 | 206 | 170 | 159 | 150 | 140 | 128 | 112 | 92,7 | 69,4 | | | | | | | | | | |
| SX6-30/10 (N) | 18,5 | 25 | 228 | 187 | 176 | 165 | 154 | 140 | 123 | 101 | 75 | | | | | | | | | | |
| SX6-30/11 (N) | 22 | 30 | 251 | 206 | 193 | 181 | 169 | 154 | 135 | 111 | 82,2 | | | | | | | | | | |
| SX6-30/12 (N) | 22 | 30 | 272 | 223 | 209 | 196 | 182 | 166 | 145 | 119 | 87,2 | | | | | | | | | | |
| SX6-30/13 (N) | 26 | 35 | 300 | 247 | 232 | 218 | 204 | 187 | 165 | 137 | 104 | | | | | | | | | | |
| SX6-30/14 (N) | 26 | 35 | 322 | 265 | 249 | 234 | 218 | 200 | 176 | 146 | 110 | | | | | | | | | | |
| SX6-30/15 (N) | 30 | 40 | 344 | 282 | 266 | 249 | 233 | 213 | 187 | 155 | 116 | | | | | | | | | | |
| SX6-30/16 (N) | 30 | 40 | 365 | 300 | 282 | 265 | 247 | 225 | 198 | 164 | 122 | | | | | | | | | | |
| SX6-30/17 (N) | 37 | 50 | 390 | 320 | 301 | 283 | 264 | 241 | 212 | 175 | 131 | | | | | | | | | | |
| SX6-30/18 (N) | 37 | 50 | 411 | 338 | 318 | 298 | 278 | 254 | 223 | 184 | 137 | | | | | | | | | | |
| SX6-30/19 (N) | 37 | 50 | 433 | 355 | 334 | 313 | 292 | 266 | 233 | 192 | 142 | | | | | | | | | | |
| SX6-30/20 (N) | 37 | 50 | 454 | 372 | 350 | 328 | 306 | 278 | 243 | 200 | 147 | | | | | | | | | | |
| SX6-30/21 (N) | 45 | 60 | 481 | 396 | 372 | 349 | 326 | 298 | 262 | 217 | 163 | | | | | | | | | | |
| SX6-30/22 (N) | 45 | 60 | 503 | 413 | 389 | 365 | 341 | 311 | 273 | 226 | 169 | | | | | | | | | | |
| SX6-30/23 (N) | 45 | 60 | 525 | 431 | 405 | 380 | 355 | 324 | 284 | 235 | 175 | | | | | | | | | | |
| SX6-30/24 (N) | 45 | 60 | 546 | 448 | 421 | 395 | 369 | 336 | 295 | 243 | 180 | | | | | | | | | | |
| SX6-30/25 (N) | 55 | 75 | 584 | 481 | 453 | 427 | 400 | 367 | 325 | 272 | 209 | | | | | | | | | | |
| SX6-30/26 (N) | 55 | 75 | 606 | 499 | 470 | 443 | 415 | 381 | 337 | 282 | 217 | | | | | | | | | | |
| SX6-30/27 (N) | 55 | 75 | 629 | 518 | 488 | 459 | 430 | 395 | 349 | 292 | 224 | | | | | | | | | | |
| SX6-30/28 (N) | 55 | 75 | 651 | 536 | 505 | 476 | 445 | 408 | 361 | 302 | 231 | | | | | | | | | | |

| DN | MOTOR | H mm | kg |
|-------|-------|-------|------|
| Rp 3" | 6" | 620 | 14,7 |
| | | 705 | 16,8 |
| | | 790 | 18,9 |
| | | 876 | 21 |
| | | 961,5 | 23,1 |
| | | 1047 | 25,4 |
| | | 1132 | 27,3 |
| | 1218 | 29,4 | |
| | 1303 | 31,5 | |
| | 1389 | 33,6 | |
| | 1474 | 35,7 | |
| | 1560 | 37,8 | |
| | 1645 | 39,9 | |
| | 1730 | 42 | |
| 8" | 1816 | 44,1 | |
| | 1901 | 46,1 | |
| | 1987 | 48,2 | |
| | 2072 | 50,3 | |
| | 2157 | 52,4 | |
| | 2243 | 54,5 | |
| | 2328 | 56,6 | |
| 2414 | 58,7 | | |
| 2500 | 60,8 | | |
| 2586 | 62,9 | | |
| 2672 | 65,0 | | |
| 2758 | 67,1 | | |
| 2844 | 69,2 | | |
| 2930 | 71,3 | | |
| 3016 | 73,4 | | |
| 3102 | 75,5 | | |

The encumbered dimensions and weight are indicative.

SX6-46

6" SUBMERSIBLE PUMPS

60 Hz - $n \approx 3450$ rpm

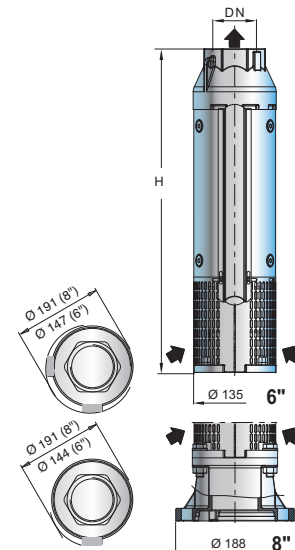
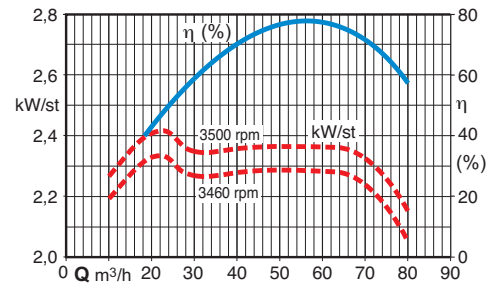
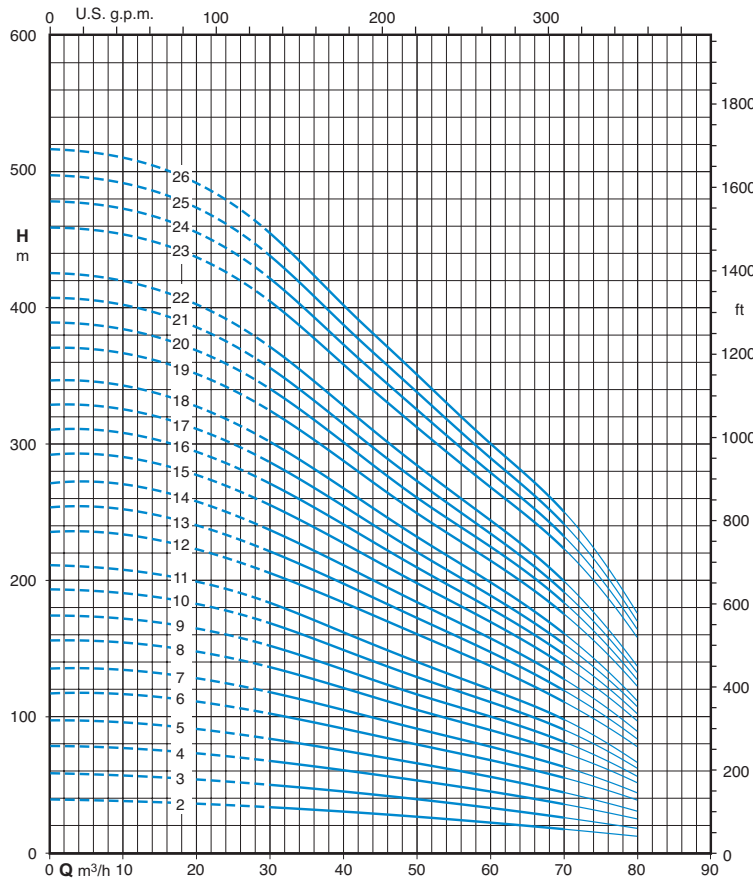

| TYPE | MOTOR | | Q m³/h l/min | DELIVERY | | | | | | | | | | | |
|---------------|-------|------|--------------------|----------|------|------|------|------|------|------|------|------|------|------|--|
| | kW | HP | | 0 | 30 | 35 | 40 | 45 | 50 | 55 | 60 | 65 | 70 | 75 | |
| SX6-46/2 (N) | 5,5 | 7,5 | H m HEAD | 38,9 | 33,7 | 31,6 | 29,6 | 28,1 | 26,3 | 24,6 | 22,6 | 20,7 | 18,1 | 15,5 | |
| SX6-46/3 (N) | 7,5 | 10 | | 57,9 | 50 | 46,9 | 44 | 41,7 | 39 | 36,5 | 33,5 | 30,7 | 26,7 | 22,8 | |
| SX6-46/4 (N) | 9,3 | 12,5 | | 78,1 | 67,6 | 63,5 | 59,5 | 56,4 | 52,9 | 49,4 | 45,5 | 41,7 | 36,4 | 31,2 | |
| SX6-46/5 (N) | 11 | 15 | | 97,1 | 83,8 | 78,7 | 73,8 | 69,9 | 65,5 | 61,2 | 56,3 | 51,5 | 44,9 | 38,4 | |
| SX6-46/6 (N) | 15 | 20 | | 118 | 103 | 96,9 | 90,9 | 85,6 | 79,5 | 73,2 | 67,5 | 62,6 | 56,4 | 48,3 | |
| SX6-46/7 (N) | 15 | 20 | | 136 | 118 | 112 | 105 | 98,4 | 91,2 | 83,9 | 77,5 | 71,7 | 64,5 | 54,8 | |
| SX6-46/8 (N) | 18,5 | 25 | | 157 | 136 | 129 | 121 | 114 | 105 | 97 | 89,5 | 82,9 | 74,7 | 63,8 | |
| SX6-46/9 (N) | 22 | 30 | | 175 | 151 | 143 | 134 | 126 | 117 | 108 | 99,4 | 91,9 | 82,6 | 70,1 | |
| SX6-46/10 (N) | 22 | 30 | | 194 | 168 | 159 | 149 | 140 | 130 | 119 | 110 | 102 | 91,5 | 77,6 | |
| SX6-46/11 (N) | 26 | 35 | | 212 | 183 | 173 | 162 | 152 | 141 | 129 | 120 | 110 | 99 | 83,4 | |
| SX6-46/12 (N) | 30 | 40 | | 236 | 206 | 195 | 183 | 172 | 160 | 147 | 136 | 126 | 114 | 97,5 | |
| SX6-46/13 (N) | 30 | 40 | | 255 | 222 | 210 | 197 | 185 | 172 | 158 | 146 | 135 | 122 | 104 | |
| SX6-46/14 (N) | 30 | 40 | | 273 | 237 | 224 | 210 | 198 | 184 | 169 | 156 | 145 | 130 | 111 | |
| SX6-46/15 (N) | 37 | 50 | | 294 | 255 | 241 | 226 | 213 | 198 | 182 | 168 | 156 | 140 | 120 | |
| SX6-46/16 (N) | 37 | 50 | | 312 | 271 | 256 | 240 | 226 | 210 | 193 | 178 | 165 | 148 | 126 | |
| SX6-46/17 (N) | 37 | 50 | | 330 | 286 | 270 | 253 | 239 | 221 | 203 | 188 | 174 | 156 | 133 | |
| SX6-46/18 (N) | 45 | 60 | | 348 | 301 | 284 | 266 | 251 | 232 | 214 | 197 | 182 | 164 | 139 | |
| SX6-46/19 (N) | 45 | 60 | | 372 | 323 | 305 | 286 | 270 | 251 | 230 | 213 | 197 | 178 | 152 | |
| SX6-46/20 (N) | 45 | 60 | | 390 | 339 | 320 | 300 | 283 | 262 | 241 | 223 | 206 | 186 | 158 | |
| SX6-46/21 (N) | 45 | 60 | | 408 | 354 | 335 | 314 | 295 | 274 | 252 | 233 | 215 | 194 | 165 | |
| SX6-46/22 (N) | 45 | 60 | | 426 | 369 | 349 | 327 | 308 | 285 | 263 | 242 | 224 | 202 | 171 | |
| SX6-46/23 (N) | 55 | 75 | | 460 | 402 | 381 | 357 | 337 | 314 | 289 | 266 | 248 | 224 | 195 | |
| SX6-46/24 (N) | 55 | 75 | | 479 | 419 | 396 | 372 | 351 | 327 | 301 | 277 | 258 | 233 | 202 | |
| SX6-46/25 (N) | 55 | 75 | | 498 | 436 | 412 | 387 | 365 | 340 | 312 | 288 | 268 | 242 | 210 | |
| SX6-46/26 (N) | 55 | 75 | | 517 | 452 | 428 | 401 | 378 | 352 | 324 | 299 | 278 | 251 | 217 | |

| DN | MOTOR | H mm | kg |
|-------|-------|------|------|
| Rp 3" | 6" | 592 | 13,5 |
| | | 705 | 16,2 |
| | | 819 | 18,8 |
| | | 933 | 21,4 |
| | | 1047 | 24,0 |
| | | 1161 | 26,6 |
| | | 1275 | 29,2 |
| | | 1389 | 31,8 |
| | | 1503 | 34,4 |
| | | 1617 | 37,0 |
| | | 1730 | 39,6 |
| | | 1844 | 42,2 |
| Rp 3" | 8" | 1958 | 44,8 |
| | | 2072 | 47,4 |
| | | 2186 | 50,1 |
| | | 2300 | 52,7 |
| | | 2414 | 55,3 |
| | | 2527 | 57,9 |
| | | 2641 | 60,5 |
| | | 2755 | 63,1 |
| | | 2869 | 65,7 |
| | | 3083 | 74,5 |
| 3196 | 77 | | |
| 3310 | 79,5 | | |
| 3424 | 82,5 | | |

The encumbered dimensions and weight are indicative.

SX6-65

6" SUBMERSIBLE PUMPS

60 Hz - $n \approx 3450$ rpm

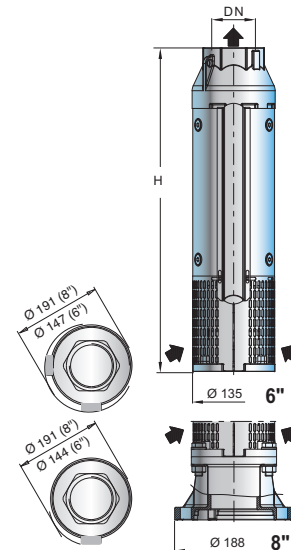
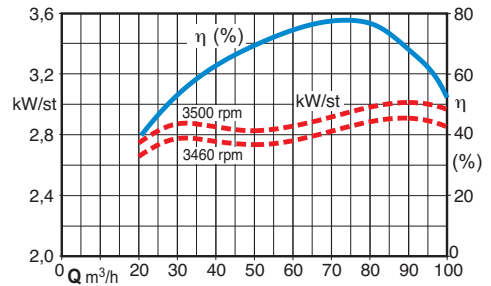
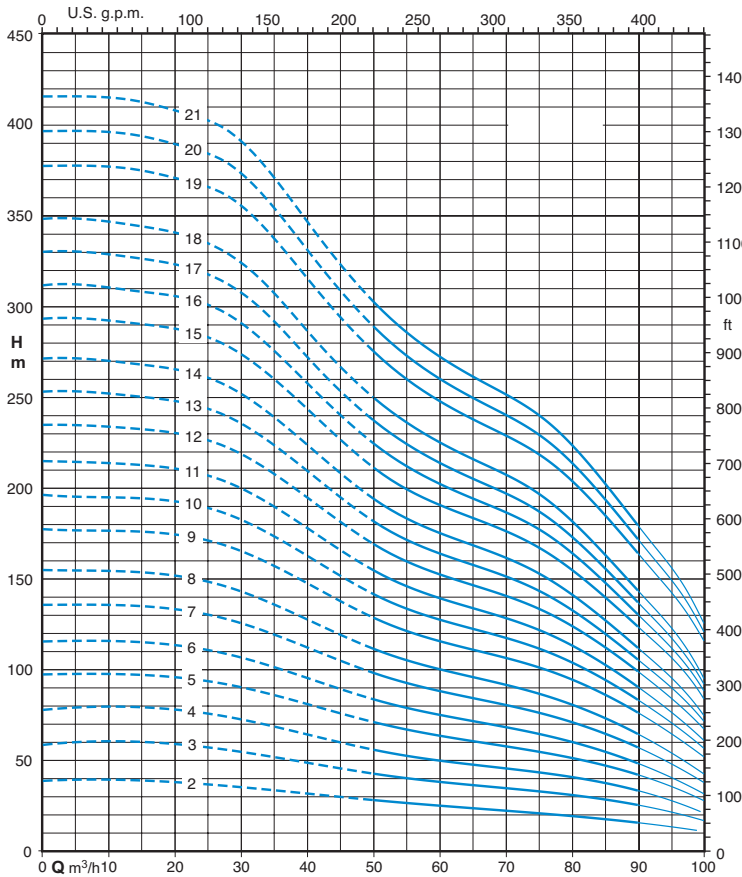

| TYPE | MOTOR | | Q m³/h l/min | DELIVERY | | | | | | | | | | | |
|---------------|-------|------|--------------------|----------|------|------|------|------|------|------|------|------|------|-----|--|
| | kW | HP | | H m HEAD | | | | | | | | | | | |
| | | | | 0 | 45 | 50 | 55 | 60 | 65 | 70 | 75 | 80 | 90 | 100 | |
| SX6-65/2 (N) | 5,5 | 7,5 | 39 | 29,4 | 27,3 | 25,3 | 24,5 | 23,8 | 22,7 | 22 | 20,3 | 15,9 | 10 | | |
| SX6-65/3 (N) | 9,3 | 12,5 | 59,6 | 45,5 | 42,1 | 39,2 | 37,6 | 36,7 | 35 | 34 | 31,7 | 25,2 | 16,9 | | |
| SX6-65/4 (N) | 11 | 15 | 78,8 | 59,8 | 55,4 | 51,5 | 49,6 | 48,2 | 46 | 44,7 | 41,3 | 32,6 | 21,3 | | |
| SX6-65/5 (N) | 15 | 20 | 97,8 | 75,5 | 70,7 | 66,5 | 63,7 | 61,1 | 58,5 | 55,9 | 52 | 41,1 | 27,8 | | |
| SX6-65/6 (N) | 18,5 | 25 | 116 | 89 | 83,3 | 78,3 | 75,1 | 72 | 68,8 | 65,6 | 60,7 | 47,7 | 31,4 | | |
| SX6-65/7 (N) | 18,5 | 25 | 136 | 105 | 97,9 | 92,1 | 88,3 | 84,7 | 81 | 77,3 | 71,7 | 56,4 | 37,6 | | |
| SX6-65/8 (N) | 22 | 30 | 155 | 119 | 111 | 105 | 100 | 96,3 | 92 | 87,8 | 81,2 | 63,9 | 42,2 | | |
| SX6-65/9 (N) | 26 | 35 | 177 | 138 | 129 | 121 | 116 | 112 | 107 | 102 | 95,2 | 75,6 | 52,2 | | |
| SX6-65/10 (N) | 30 | 40 | 196 | 152 | 142 | 134 | 128 | 123 | 118 | 112 | 105 | 82,8 | 56,5 | | |
| SX6-65/11 (N) | 30 | 40 | 215 | 166 | 155 | 146 | 140 | 134 | 128 | 122 | 114 | 89,8 | 60,5 | | |
| SX6-65/12 (N) | 37 | 50 | 235 | 181 | 170 | 159 | 153 | 147 | 140 | 134 | 125 | 98,5 | 66,6 | | |
| SX6-65/13 (N) | 37 | 50 | 253 | 195 | 182 | 171 | 164 | 158 | 151 | 144 | 134 | 105 | 70,3 | | |
| SX6-65/14 (N) | 37 | 50 | 271 | 208 | 195 | 183 | 176 | 168 | 161 | 154 | 142 | 112 | 73,7 | | |
| SX6-65/15 (N) | 45 | 60 | 293 | 227 | 212 | 199 | 191 | 183 | 175 | 168 | 156 | 123 | 83,4 | | |
| SX6-65/16 (N) | 45 | 60 | 312 | 240 | 225 | 211 | 203 | 195 | 186 | 178 | 165 | 130 | 87,3 | | |
| SX6-65/17 (N) | 45 | 60 | 330 | 254 | 238 | 223 | 214 | 205 | 196 | 187 | 174 | 137 | 90,9 | | |
| SX6-65/18 (N) | 45 | 60 | 348 | 267 | 250 | 235 | 226 | 216 | 207 | 197 | 182 | 143 | 94,4 | | |
| SX6-65/19 (N) | 55 | 75 | 378 | 295 | 276 | 260 | 248 | 239 | 229 | 219 | 205 | 164 | 116 | | |
| SX6-65/20 (N) | 55 | 75 | 397 | 310 | 290 | 273 | 261 | 251 | 240 | 230 | 215 | 172 | 121 | | |
| SX6-65/21 (N) | 55 | 75 | 416 | 324 | 303 | 285 | 273 | 263 | 251 | 240 | 225 | 180 | 126 | | |

| DN | MOTOR | H mm | kg | |
|------|-------|------|------|------|
| Rp | 6" | 592 | 13,6 | |
| | | 705 | 16,2 | |
| | | 819 | 18,8 | |
| | | 933 | 21,4 | |
| | | 1047 | 24,0 | |
| | | 1161 | 26,7 | |
| | 3" | 1275 | 29,3 | |
| | | 1389 | 31,9 | |
| | | 1503 | 34,5 | |
| | | 1617 | 37,1 | |
| | | 8" | 1730 | 39,7 |
| | | | 1844 | 42,4 |
| 1958 | 44,9 | | | |
| 2072 | 47,5 | | | |
| 2186 | 50,2 | | | |
| 2300 | 52,8 | | | |
| | | 2414 | 55,4 | |
| | | 2627 | 64 | |
| | | 2741 | 66,5 | |
| | | 2855 | 69,5 | |

The encumbered dimensions and weight are indicative.

SX8-78

8" SUBMERSIBLE PUMPS

60 Hz - $n \approx 3450$ rpm

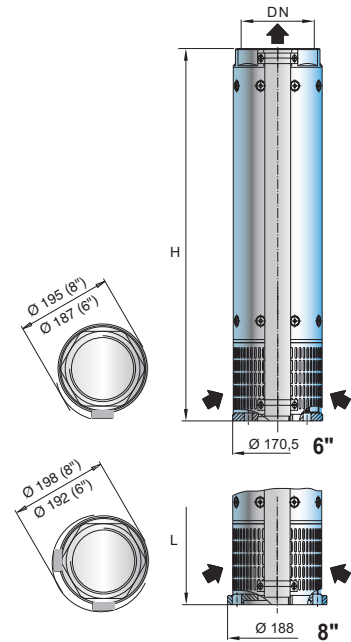
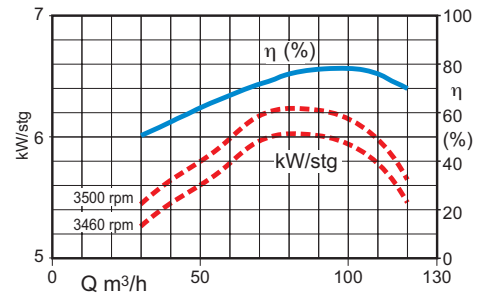
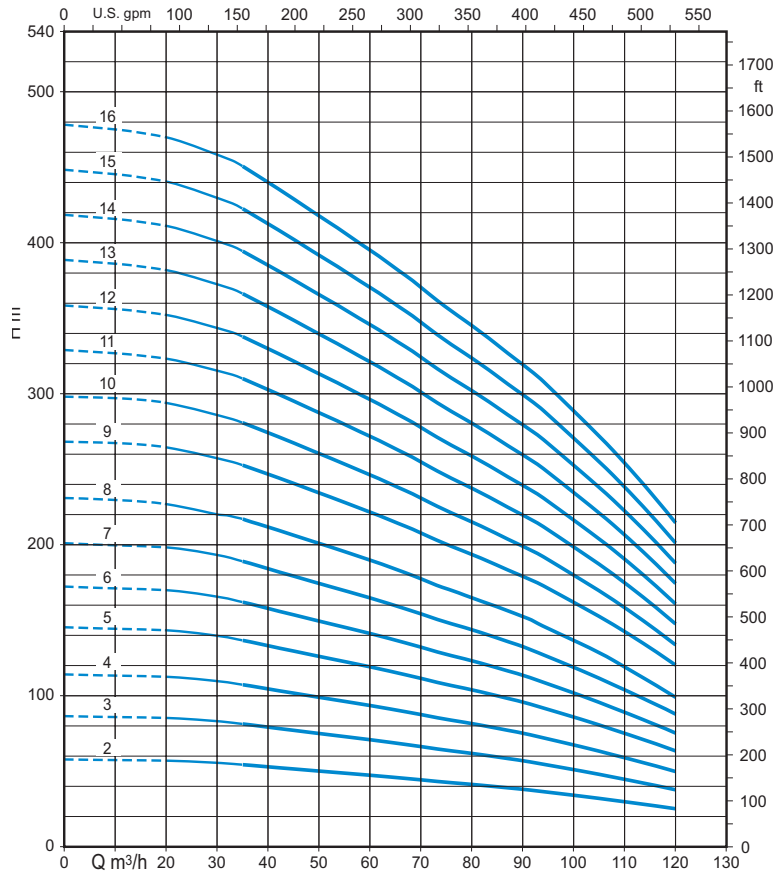

| TYPE | MOTOR | | Q m³/h l/min | DELIVERY | | | | | | | | | | | |
|---------------|-------|-----|--------------------|----------|-----|------|------|-----|------|------|------|------|-------|------|------|
| | kW | HP | | 0 | 20 | 30 | 40 | 50 | 60 | 70 | 80 | 90 | 100 | 110 | 120 |
| SX8-78/2 (N) | 11 | 15 | H m HEAD | 58 | 58 | 56 | 53.5 | 50 | 48 | 45 | 41 | 39 | 35 | 30 | 25 |
| SX8-78/3 (N) | 18.5 | 25 | | 86 | 85 | 83.5 | 80 | 75 | 70 | 66.5 | 62 | 57.5 | 50 | 45 | 39 |
| SX8-78/4 (N) | 22 | 30 | | 114 | 113 | 110 | 105 | 99 | 93.5 | 88 | 81.5 | 75 | 68 | 59 | 50 |
| SX8-78/5 (N) | 30 | 40 | | 145 | 143 | 140 | 133 | 126 | 120 | 111 | 104 | 96.5 | 86.5 | 76.5 | 65 |
| SX8-78/6 (N) | 37 | 50 | | 172 | 170 | 166 | 159 | 150 | 141 | 132 | 123 | 113 | 101 | 89 | 76.5 |
| SX8-78/7 (N) | 45 | 60 | | 201 | 198 | 193 | 185 | 175 | 165 | 155 | 144 | 133 | 120 | 105 | 89 |
| SX8-78/8 (N) | 45 | 60 | | 230 | 228 | 220 | 211 | 200 | 190 | 178 | 165 | 152 | 137 | 120 | 99.5 |
| SX8-78/9 (N) | 55 | 75 | | 269 | 265 | 257 | 247 | 235 | 221 | 208 | 192 | 180 | 162 | 141 | 120 |
| SX8-78/10 (N) | 55 | 75 | | 298 | 295 | 286 | 275 | 260 | 246 | 230 | 215 | 199 | 180 | 159 | 133 |
| SX8-78/11 (N) | 75 | 100 | | 330 | 322 | 316 | 302 | 287 | 271 | 255 | 237 | 220 | 199.5 | 175 | 149 |
| SX8-78/12 (N) | 75 | 100 | | 359 | 352 | 343 | 330 | 313 | 296 | 278 | 259 | 239 | 217 | 190 | 160 |
| SX8-78/13 (N) | 75 | 100 | | 389 | 381 | 372 | 358 | 340 | 320 | 300 | 280 | 260 | 235 | 207 | 175 |
| SX8-78/14 (N) | 92 | 125 | | 419 | 411 | 400 | 385 | 367 | 346 | 325 | 300 | 280 | 251 | 220 | 189 |
| SX8-78/15 (N) | 92 | 125 | | 449 | 440 | 430 | 412 | 391 | 370 | 347 | 322 | 300 | 270 | 239 | 200 |
| SX8-78/16 (N) | 92 | 125 | | 479 | 470 | 459 | 440 | 418 | 395 | 370 | 345 | 320 | 288 | 252 | 215 |

| DN | MOTOR | H mm | kg |
|----------|-------|---------|------|
| Rp 5" | 6" | 644 | 31.5 |
| | | 770 | 36.5 |
| | | 896 | 41.5 |
| | 8" | 1022 | 46 |
| | | 1148 | 51 |
| | | 1274 | 56 |
| | | 1400 | 61 |
| | | 1531 | 67 |
| | | 1657 | 72 |
| | | 1783 | 77 |
| 1909 | 82 | | |
| 2035 | 87 | | |
| 2161 | 92 | | |
| 2287 | 97 | | |
| 2413 | 101.5 | | |

The encumbered dimensions and weight are indicative.

SX8-97

8" SUBMERSIBLE PUMPS

60 Hz - $n \approx 3450$ rpm

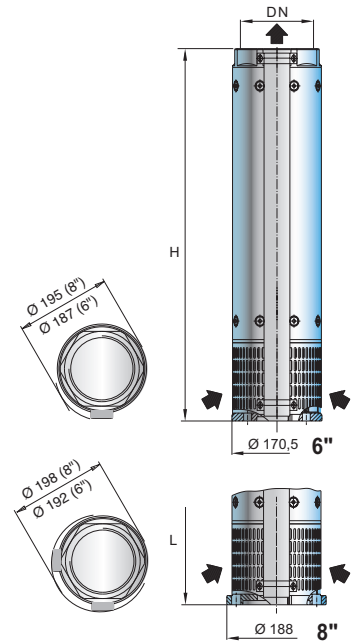
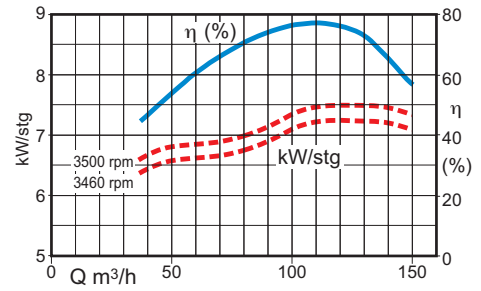
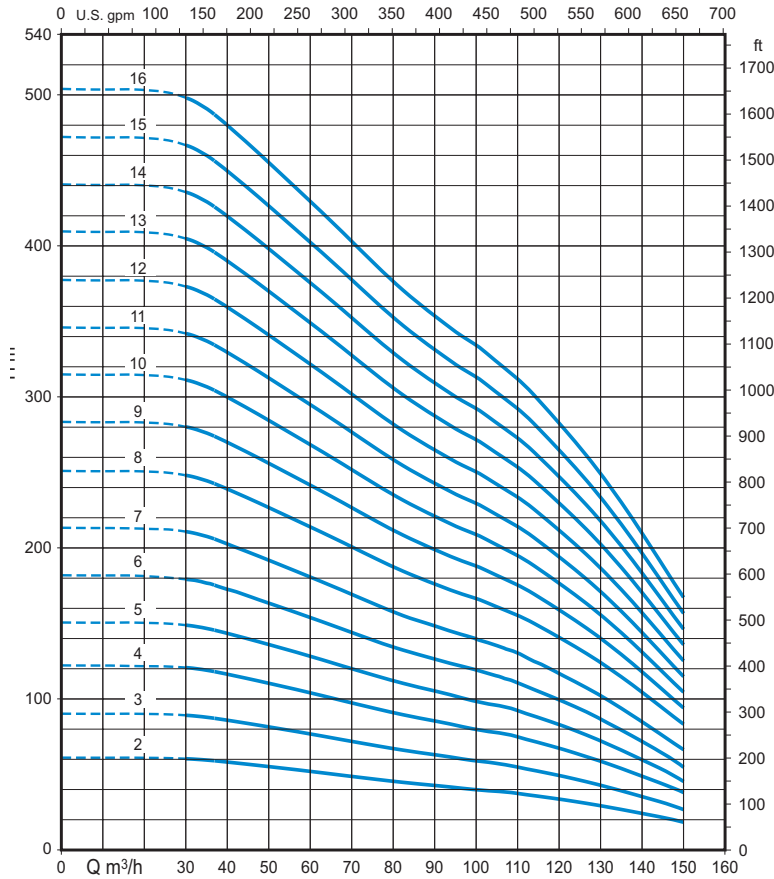

| TYPE | MOTOR | | Q m³/h l/min | DELIVERY | | | | | | | | | | | |
|---------------|-------|-----|--------------------|----------|-------|------|------|-------|------|------|------|------|------|--|--|
| | kW | HP | | 0 | 30 | 45 | 60 | 75 | 90 | 105 | 120 | 135 | 150 | | |
| | | | | 0 | 500 | 750 | 1000 | 1250 | 1500 | 1750 | 2000 | 2250 | 2500 | | |
| SX8-97/2 (N) | 15 | 20 | H m HEAD | 60 | 60 | 57 | 52 | 48 | 42 | 39,5 | 35 | 28 | 19 | | |
| SX8-97/3 (N) | 22 | 30 | | 90 | 90 | 83,5 | 77,5 | 70 | 62,5 | 58 | 49,5 | 40 | 27 | | |
| SX8-97/4 (N) | 30 | 40 | | 122 | 120 | 114 | 104 | 95 | 85 | 79 | 69 | 55 | 39 | | |
| SX8-97/5 (N) | 37 | 50 | | 150 | 149,5 | 140 | 129 | 116 | 106 | 96,5 | 83 | 67 | 46 | | |
| SX8-97/6 (N) | 45 | 60 | | 181 | 180 | 169 | 154 | 139,5 | 127 | 115 | 100 | 80 | 55 | | |
| SX8-97/7 (N) | 45 | 60 | | 213 | 210 | 198 | 180 | 163,5 | 149 | 135 | 117 | 93,5 | 68 | | |
| SX8-97/8 (N) | 55 | 75 | | 250 | 249 | 232 | 215 | 195 | 176 | 160 | 140 | 115 | 83 | | |
| SX8-97/9 (N) | 75 | 100 | | 283 | 280 | 262 | 240 | 219 | 200 | 181 | 159 | 130 | 95 | | |
| SX8-97/10 (N) | 75 | 100 | | 315 | 310 | 292 | 269 | 243,5 | 220 | 200 | 178 | 143 | 105 | | |
| SX8-97/11 (N) | 75 | 100 | | 346 | 341 | 320 | 295 | 269 | 242 | 220 | 194 | 159 | 115 | | |
| SX8-97/12 (N) | 92 | 125 | | 378 | 372 | 350 | 320 | 290 | 265 | 241 | 211 | 171 | 125 | | |
| SX8-97/13 (N) | 92 | 125 | | 410 | 405 | 380 | 350 | 317 | 289 | 262 | 230 | 188 | 137 | | |
| SX8-97/14 (N) | 92 | 125 | | 440 | 435 | 410 | 375 | 340 | 310 | 282 | 248 | 200 | 148 | | |
| SX8-97/15 (N) | 110 | 150 | | 472 | 467 | 439 | 401 | 365 | 330 | 302 | 265 | 215 | 158 | | |
| SX8-97/16 (N) | 110 | 150 | | 504 | 498 | 468 | 430 | 390 | 352 | 322 | 280 | 230 | 169 | | |

| DN | MOTOR | H mm | kg |
|-------|-------|------|-------|
| Rp 5" | 6" | 644 | 31.5 |
| | | 770 | 36.5 |
| | | 896 | 41.5 |
| | 8" | 1022 | 46 |
| | | 1148 | 51 |
| | | 1274 | 56 |
| | | 1405 | 62.5 |
| | | 1531 | 67 |
| | | 1657 | 72 |
| | | 1783 | 77 |
| 10" | 1909 | 82 | |
| | 2035 | 87 | |
| | | 2161 | 92 |
| | | 2287 | 97 |
| | | 2413 | 101.5 |

The encumbered dimensions and weight are indicative.

SX6

SX6 13
SX6 18
SX6 27

Drawing for dismantling and assembly

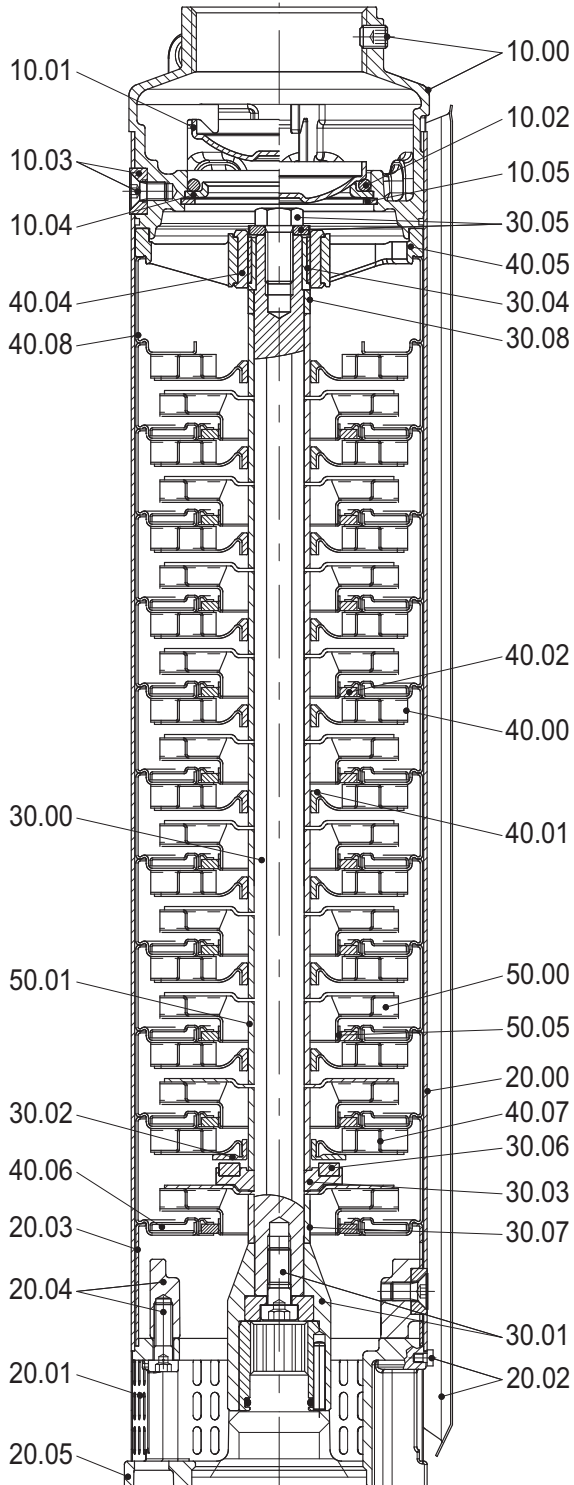

| Ref. n. | description |
|---------|--------------------------------------|
| 10 00 | Discharge head and screw |
| 10 01 | Valve |
| 10 02 | O-ring |
| 10 03 | Screws and outer case locking nuts |
| 10 04 | Valve support |
| 10 05 | Seeger ring |
| 20 00 | Outer case |
| 20 01 | Suction strainer |
| 20 02 | Cable guard and screws |
| 20 03 | Initial spacer |
| 20 04 | Flange and bolts |
| 20 05 | Motor adapter |
| 20 06 | 4" motor flange / coupling adapter |
| 30 00 | Pump shaft |
| 30 01 | Coupling |
| 30 02 | Upper up-thrust washer |
| 30 03 | Lower up-thrust washer |
| 30 04 | Upper journal sleeve |
| 30 05 | Screw and washer |
| 30 06 | Up-thrust ring |
| 30 07 | Lower spacer |
| 30 08 | Upper spacer |
| 40 00 | Diffusers |
| 40 01 | Secondary bearing bush |
| 40 02 | Floating neck ring |
| 40 04 | Bearing bush |
| 40 05 | Upper bearing guide |
| 40 06 | First diffuser |
| 40 07 | Diffuser with upper up-thrust washer |
| 40 08 | Last diffuser |
| 50 00 | Impeller |
| 50 01 | Secondary journal sleeve |
| 50 05 | Wear ring |

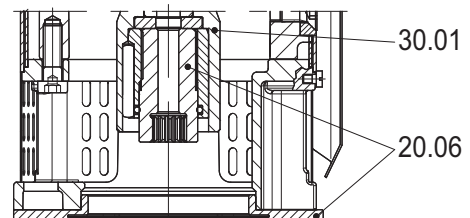

SX6

SX6 30
SX6 46
SX6 65

Drawing for dismantling and assembly

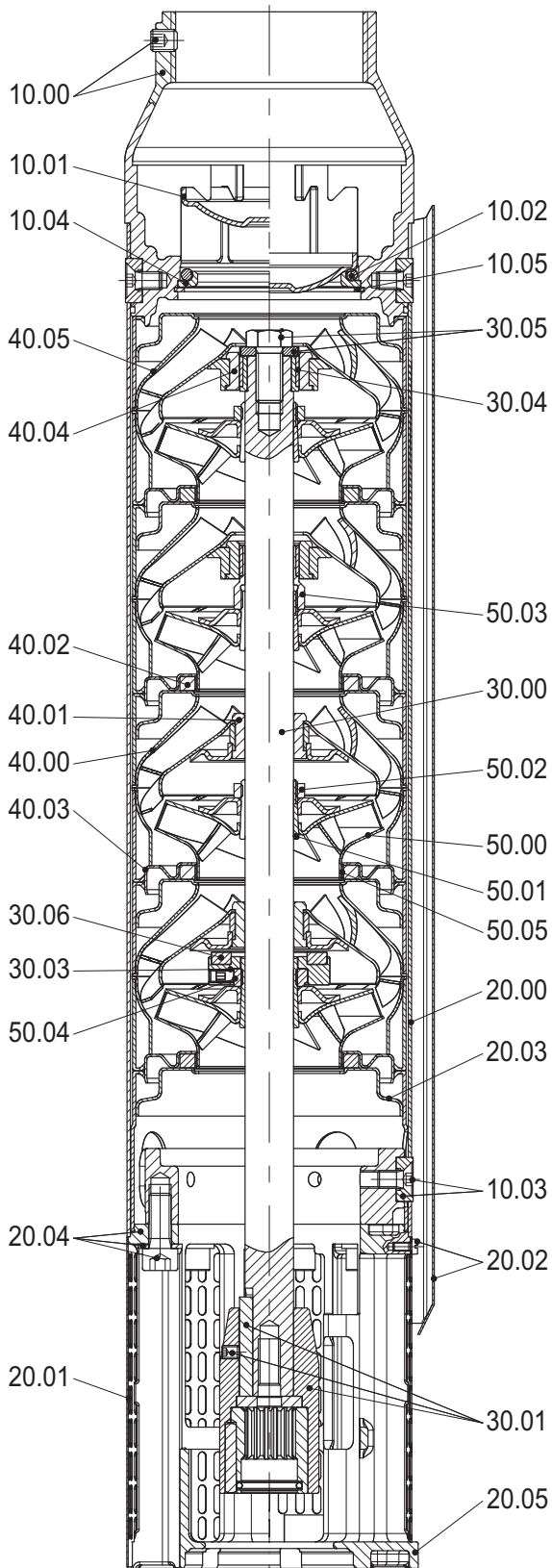

| Ref. n. | description |
|---------|-------------------------------------|
| 10 00 | Discharge head and screw |
| 10 01 | Valve |
| 10 02 | O-ring |
| 10 03 | Screws and outer case locking nuts |
| 10 04 | Valve support |
| 10 05 | Seeger ring |
| 20 00 | Outer case |
| 20 01 | Suction strainer |
| 20 02 | Cable guard and screws |
| 20 03 | Initial spacer |
| 20 04 | Flange and bolts |
| 20 05 | Motor adapter |
| 20 06 | 4" motor flange / coupling adapter |
| 20 07 | 8" motor adapter / bolts and washer |
| 30 00 | Pump shaft |
| 30 01 | Coupling |
| 30 03 | Lower up-thrust washer |
| 30 04 | Upper journal sleeve |
| 30 05 | Screw and washer |
| 30 06 | Up-thrust ring |
| 40 00 | Diffusers |
| 40 01 | Secondary bearing bush |
| 40 02 | Floating neck ring |
| 40 03 | Flange clamping neck ring |
| 40 04 | Bearing bush |
| 40 05 | Last / intermediate diffuser |
| 50 00 | Impeller |
| 50 01 | Split cone |
| 50 02 | Split cone nut |
| 50 03 | Intermediate split cone nut |
| 50 04 | Up-thrust split cone nut |
| 50 05 | Wear ring |

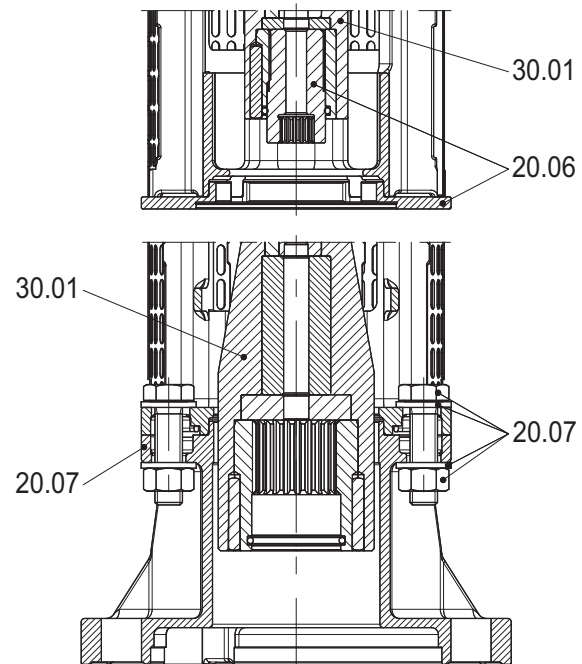

SX8

SX8 78
SX8 97

Drawing for dismantling and assembly

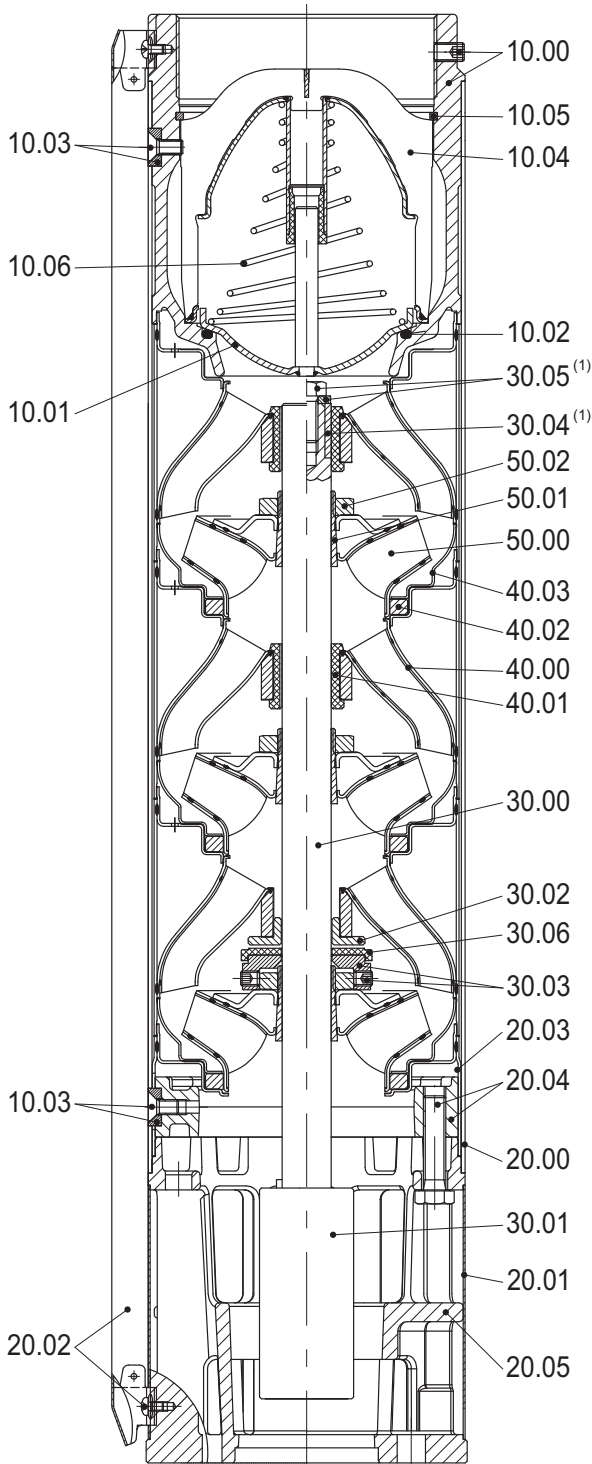

| Ref. n. | description |
|---------|---------------------------|
| 10 00 | Discharge head |
| 10 01 | Valve |
| 10 02 | Sealing O-ring |
| 10 03 | Outer case locking nuts |
| 10 04 | Valve support |
| 10 05 | Seeger ring |
| 10 06 | Spring |
| 20 00 | Outer case |
| 20 01 | Suction strainer |
| 20 02 | Cable guard |
| 20 03 | Initial spacer |
| 20 04 | Flange |
| 20 05 | Motor adapter |
| 30 00 | Pump shaft |
| 30 01 | Coupling |
| 30 02 | Upper up-thrust washer |
| 30 03 | Lower up-thrust washer |
| 30 04 | Upper journal sleeve |
| 30 05 | Screw and washer |
| 30 06 | Up-thrust ring |
| 40 00 | Diffuser |
| 40 01 | Secondary bearing bush |
| 40 02 | Floating neck ring |
| 40 03 | Flange clamping neck ring |
| 50 00 | Impeller |
| 50 01 | Split cone |
| 50 02 | Split cone nut |

1) only for types with more than 8 stages