



Construction

Submersible motor pumps for deep wells of 6" (DN 150).
Sized for connection to the motor according to NEMA Standards.
Delivery casing with built-in non-return valve. Delivery port G 3.

Impellers - radial impellers (RI-14, RI-19, RI-25)
- mixed flow impellers (RI-35, RI-40, RI-50)

Performance

Capacity up to 78 m³/h.
Head up to 375 m.
Rated motor power output up to 37 kW.
Rotation speed 3450 r.p.m. (motor frequency 60 Hz).

Applications

For clean water, non-aggressive. For water supply. For irrigation.
For civil and industrial applications. For fire fighting applications.

Operating conditions

Water temperature up to 35 °C.
Max. sand quantity into the water: 100 g/m³.
Continuous duty.

Direction of rotation: clockwise as seen the pump from the coupling side.

Materials

Components	Materials
Suction casing	Bronze
Delivery casing - Non-return valve	Brass
Impellers	NORYL GFN2
Diffusers	
Shell - Diffuser sleeve	Steel AISI 304
Wear rings - Screws	
Coupling	Steel AISI 420
Shaft	Steel AISI 430F
Bushing	Sintered steel AISI 316
Filter and Cable sheat	Steel AISI 4302B

Coverage chart

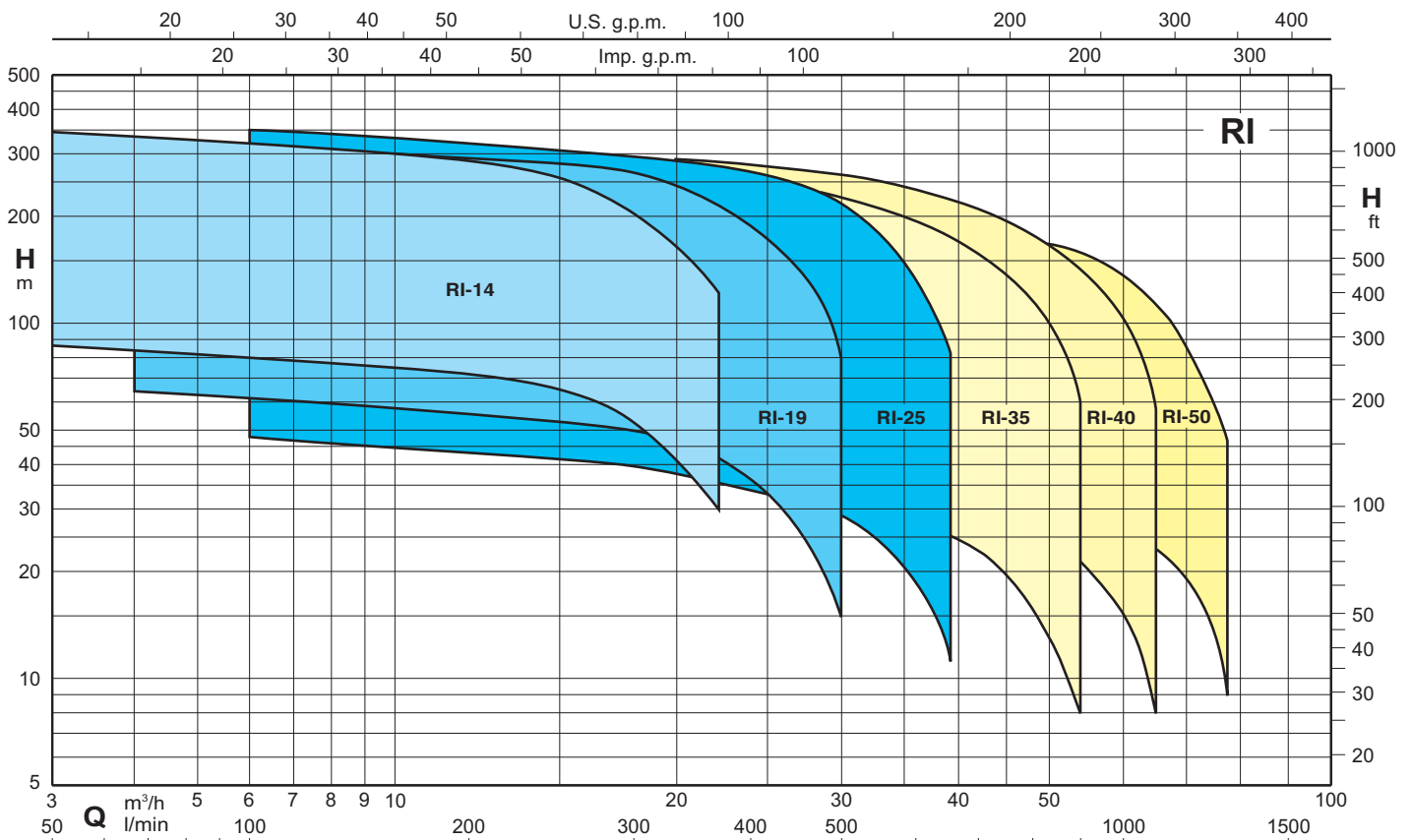

Tolerances according to ISO 9906-A

RI-14

6" SUBMERSIBLE PUMPS WITH STAINLESS STEEL CASING

60 Hz - $n \approx 3450$ rpm

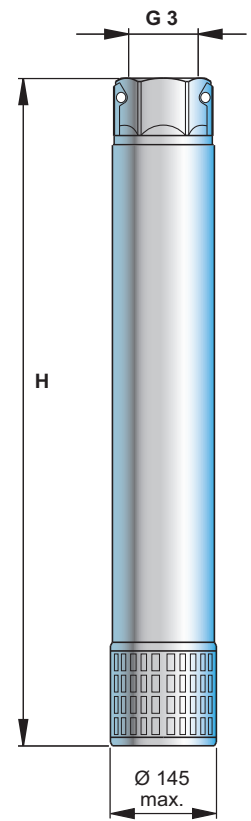
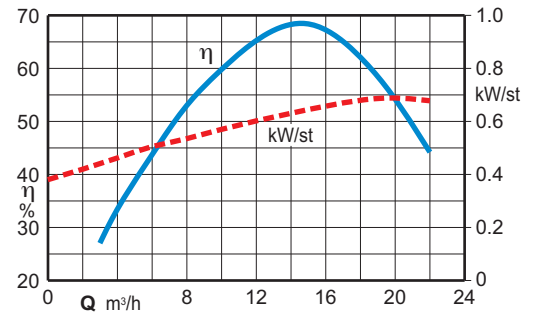
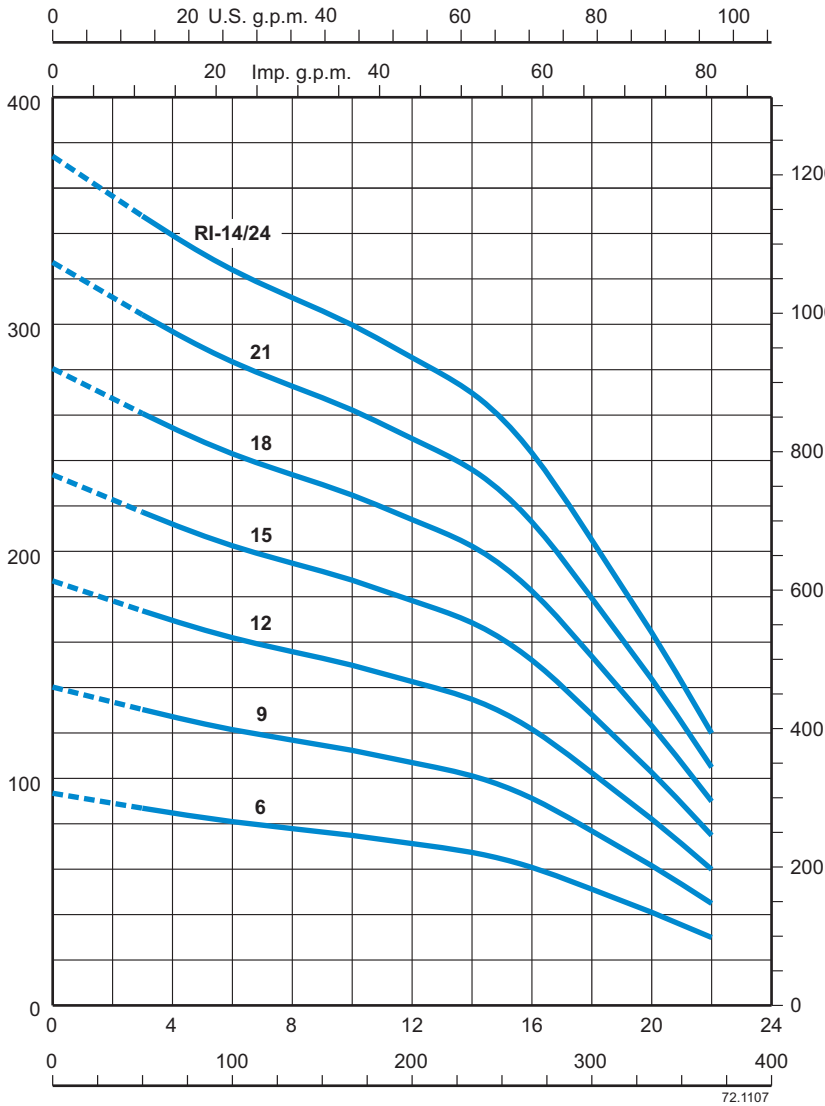

TYPE	MOTOR		Q m³/h l/min	DELIVERY											
	kW	HP		0	3	6	8	10	12	14	15	16	18	20	22
RI-14/6	4	5,5	H m HEAD	93,4	87	81	78	75	71,5	67,5	64,5	60	51,5	41	30
RI-14/9	5,5	7,5		140	131	122	117	113	107	101	96,8	91	77	61,5	45
RI-14/12	7,5	10		187	174	162	156	150	143	135	129	122	103	82	60
RI-14/15	9,2	12,5		234	218	203	195	188	179	169	161	152	128	103	75
RI-14/18	11	15		280	261	243	234	225	214	203	194	183	154	123	90
RI-14/21	13	17,5		327	305	284	273	263	250	236	225	213	180	144	105
RI-14/24	15	20		374	348	324	312	300	286	270	258	244	205	165	120

H mm	kg
560	12,8
677	14,5
793	16,2
908	17,9
1025	19,6
1141	21,3
1320	23

The encumbered dimensions and weight are indicative.

RI-19

6" SUBMERSIBLE PUMPS WITH STAINLESS STEEL CASING

60 Hz - $n \approx 3450$ rpm

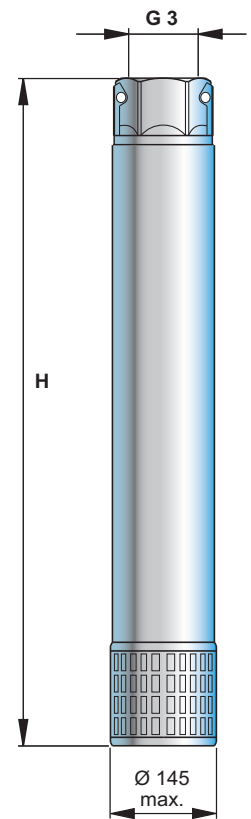
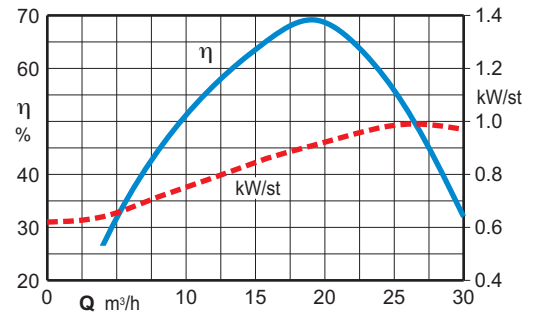
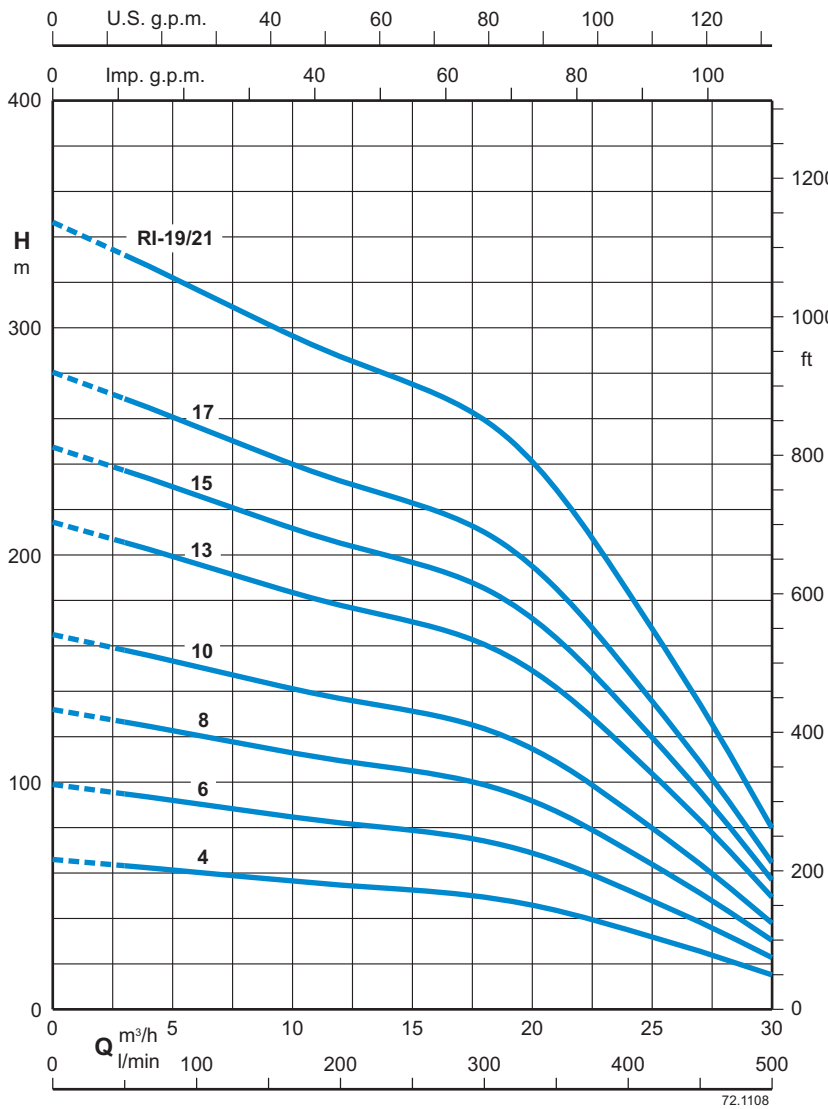

TYPE	MOTOR		Q m³/h l/min	DELIVERY											
	kW	HP		0	4	8	12	15	18	19,5	21	22,5	24	27	30
RI-19/4	4	5,5	H m HEAD	66	62,5	58,5	54,7	52	50	46,8	43,5	39,5	35	25,5	15
RI-19/6	5,5	7,5		99	93,5	87,5	82	78	75	70,2	65,5	59,3	52,5	38,5	23
RI-19/8	7,5	10		132	125	117	109	104	100	93,6	87	79,1	70	51	30,5
RI-19/10	9,2	12,5		165	156	146	137	130	125	117	109	98,9	87,5	64	38
RI-19/13	11	15		214	203	190	178	169	163	152	142	129	114	83	49,5
RI-19/15	13	17,5		247	234	219	205	195	188	176	164	148	131	96	57
RI-19/17	15	20		280	265	248	233	221	213	199	185	168	149	109	64,5
RI-19/21	18,5	25		346	327	307	287	273	263	246	229	208	184	134	80

H mm	kg
484	12,5
561	13,5
638	14,5
715	15,5
830	17
907	18
985	19
1139	21,5

The encumbered dimensions and weight are indicative.

RI-25

6" SUBMERSIBLE PUMPS WITH STAINLESS STEEL CASING

60 Hz - $n \approx 3450$ rpm

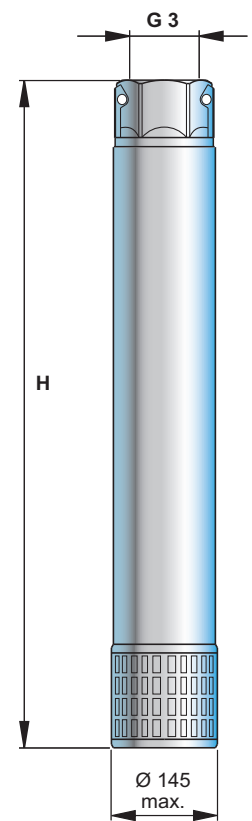
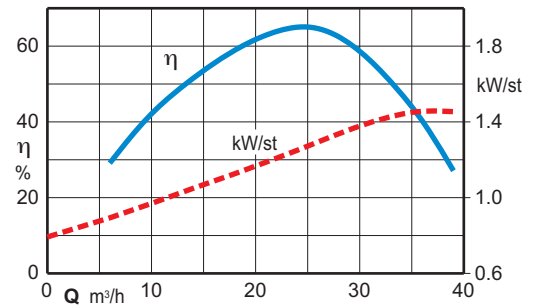
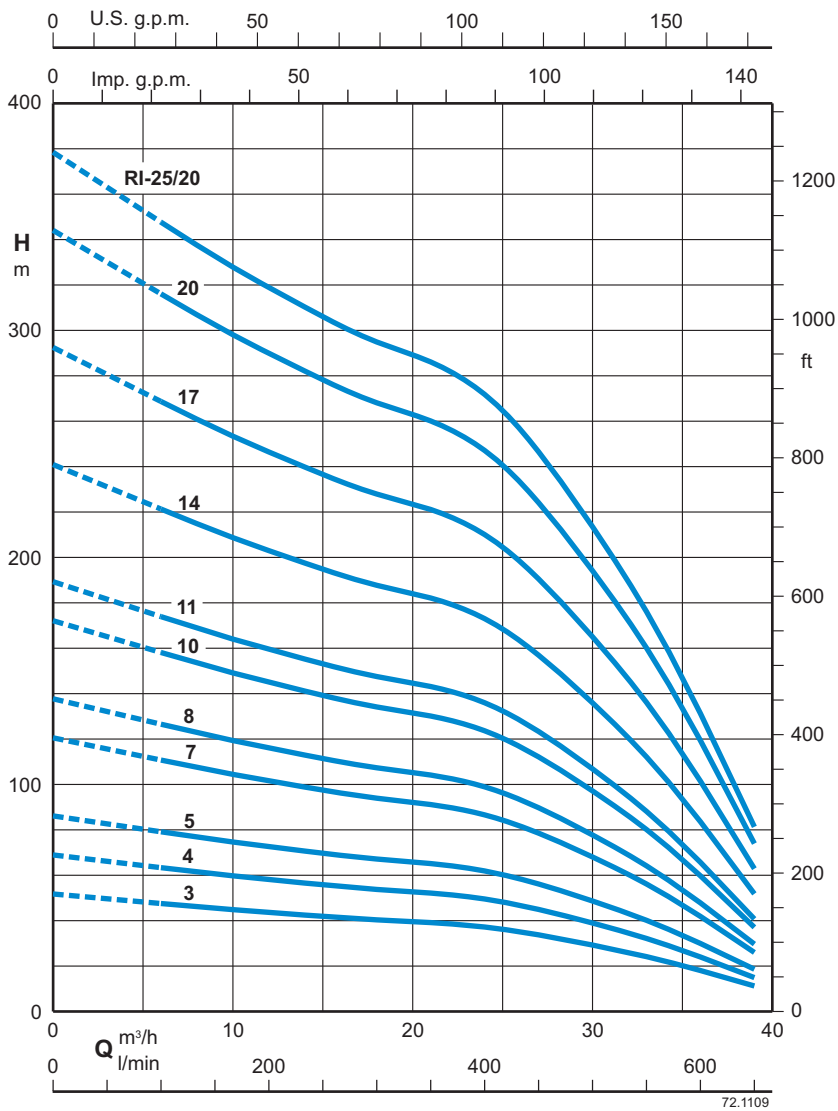

TYPE	MOTOR		Q m³/h l/min	DELIVERY												H mm	kg
	kW	HP		0	6	10	14	18	21	24	27	30	33	36	39		
RI-25/3	4	5,5	H m HEAD	51,5	47,5	44,5	42,5	40	39	37	33,5	29	24	18	11	470	12,1
RI-25/4	5,5	7,5		68,7	63	59,5	56,5	53,5	52	49,5	45	39	32	24	15	517	12,7
RI-25/5	7,5	10		85,9	79	74,5	70,5	67	65	62	56	48,5	40	30	18,5	565	13,3
RI-25/7	9,2	12,5		120	111	104	98,5	94	91	86,5	78,5	68	56	42	26	660	14,5
RI-25/8	11	15		137	126	119	113	107	104	99	89,5	77,5	64	47,5	29,5	707	15,1
RI-25/10	13	17,5		172	158	149	141	134	130	124	112	97	80	59,5	37	802	16,3
RI-25/11	15	20		189	174	164	155	147	143	136	123	107	88	65,5	40,5	850	16,9
RI-25/14	18,5	25		240	221	209	197	188	182	173	157	136	112	83,5	51,5	992	18,7
RI-25/17	22	30		292	269	253	240	228	221	210	190	165	136	101	62,5	1135	20,5
RI-25/20	26	35		344	316	298	282	268	260	247	224	194	160	119	74	1277	22,3
RI-25/22	30	40	378	348	328	310	295	286	272	246	213	176	131	81	1420	23,5	

The encumbered dimensions and weight are indicative.

RI-35

6" SUBMERSIBLE PUMPS WITH STAINLESS STEEL CASING

60 Hz - $n \approx 3450$ rpm

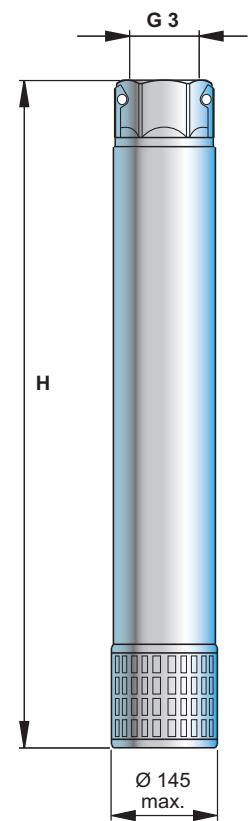
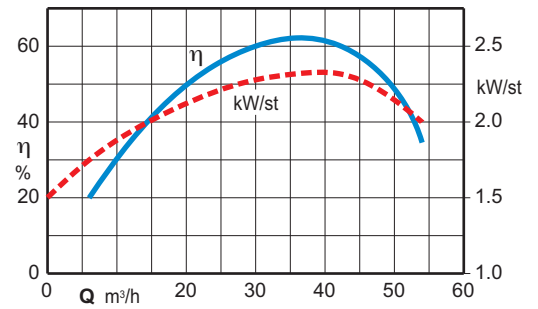
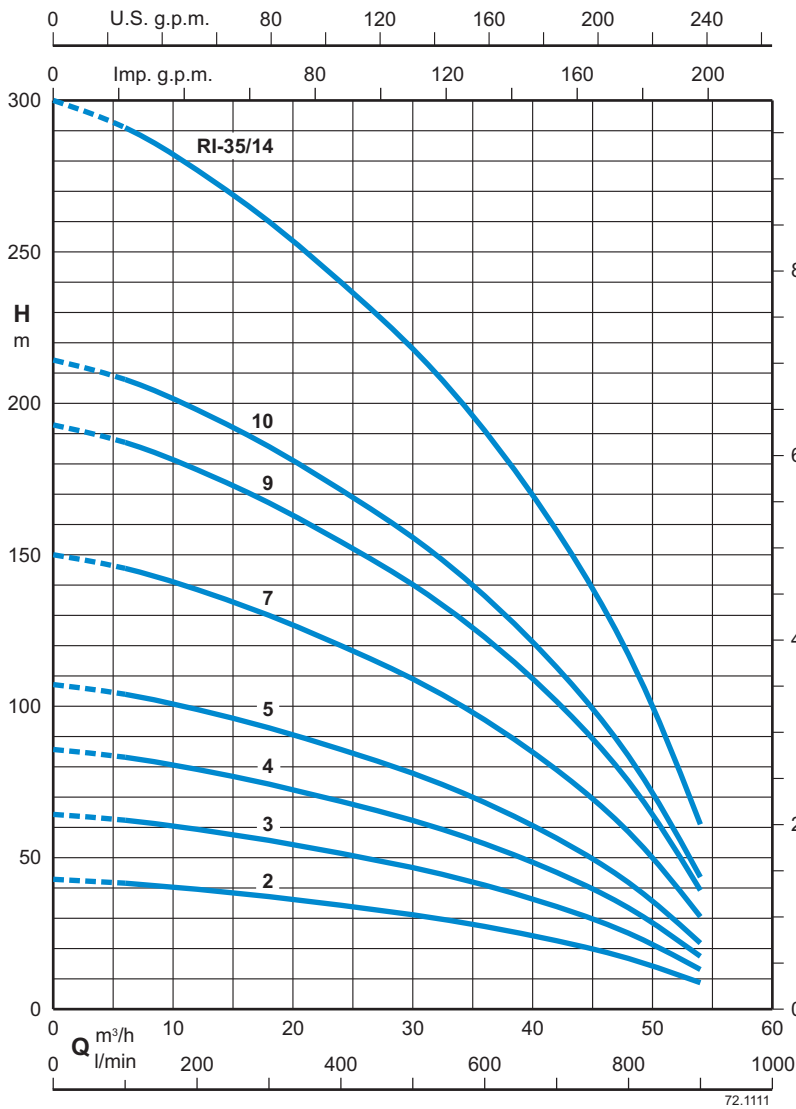

TYPE	MOTOR		Q m³/h l/min	DELIVERY											
	kW	HP		0	6	12	18	24	30	33	36	39	42	48	54
RI-35/2	5,5	7,5	H m HEAD	43	42	40	39	35	33	30	29	25	23	16	8
RI-35/3	7,5	10		65	63	60	57	52	47	45	41	37	33	23	13
RI-35/4	9,2	12,5		87	83	79	74	69	62	60	55	50	45	33	17
RI-35/5	11	15		109	105	100	94	87	79	75	68	62	56	40	21
RI-35/7	15	20		152	147	140	131	121	109	105	95	87	78	57	30
RI-35/9	18,5	25		196	188	179	167	153	137	135	118	112	95	69	39
RI-35/10	22	30		218	210	200	186	173	156	150	136	125	112	83	43
RI-35/14	30	40		305	291	277	260	240	218	210	191	175	158	117	61

H mm	kg
495	17
605	20
715	22
825	24
1040	28,5
1260	33,5
1370	35,5
1800	43,5

The encumbered dimensions and weight are indicative.

RI-40

6" SUBMERSIBLE PUMPS WITH STAINLESS STEEL CASING

60 Hz - $n \approx 3450$ rpm

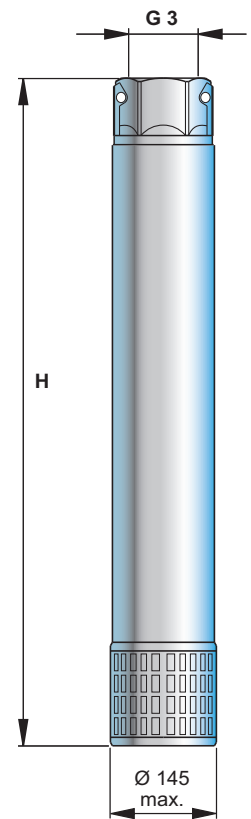
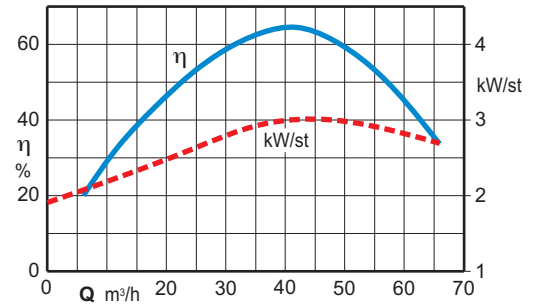
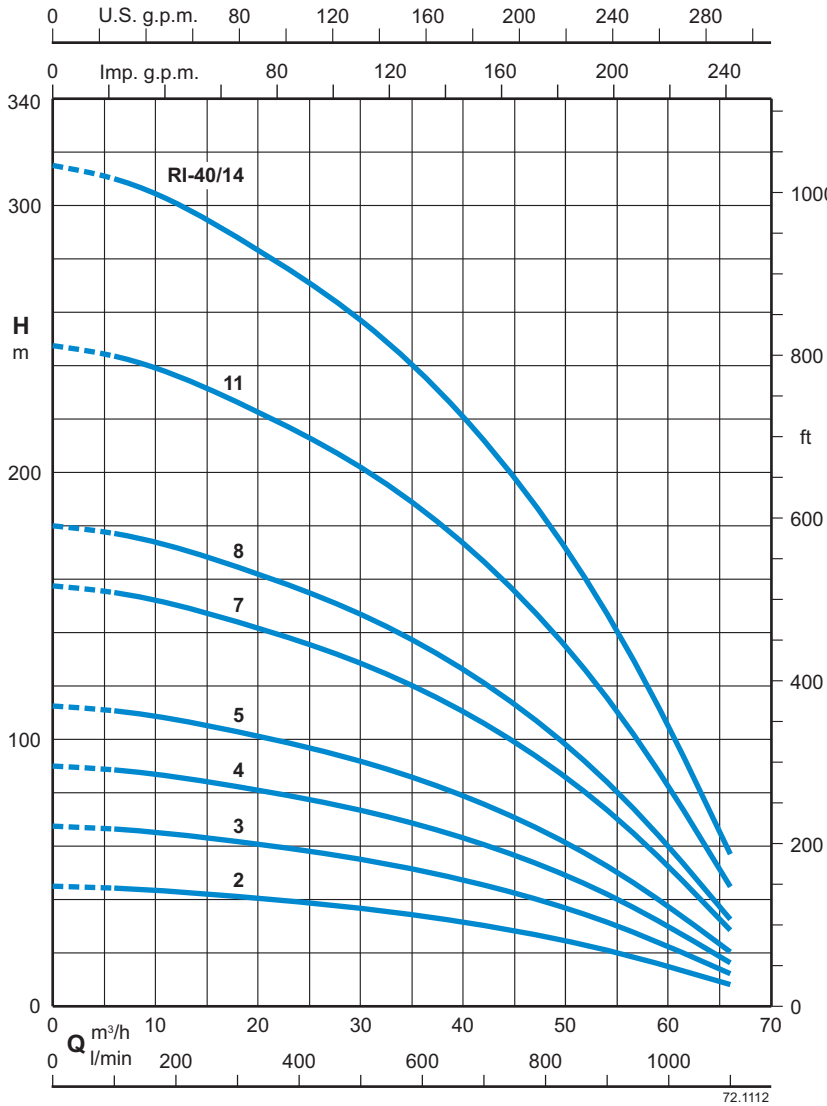

TYPE	MOTOR		Q m³/h l/min	DELIVERY												
	kW	HP		0	6	12	18	24	30	36	42	48	54	60	66	
RI-40/2	5,5	7,5	H m HEAD	45	44	43	41	39	37	34	31	27	21	15	8	
RI-40/3	9,2	12,5		68	66	64	62	59	55	51	45	39	32	22	12	
RI-40/4	11	15		91	88	86	82	79	74	68	61	51	41	29	16	
RI-40/5	15	20		113	110	107	103	98	92	85	75	65	52	37	20	
RI-40/7	18,5	25		159	153	149	144	137	129	119	106	91	73	51	28	
RI-40/8	22	30		181	177	172	165	157	148	135	121	104	83	60	32	
RI-40/11	30	40		249	244	237	228	216	203	187	166	142	115	82	45	
RI-40/14	37	50		317	310	300	288	275	257	237	212	183	147	104	57	

H mm	kg
495	17
605	20
715	22
825	24
1040	28,5
1150	31
1475	38,5
1800	43,5

The encumbered dimensions and weight are indicative.

RI-50

6" SUBMERSIBLE PUMPS
WITH STAINLESS STEEL CASING

60 Hz - $n \approx 3450$ rpm

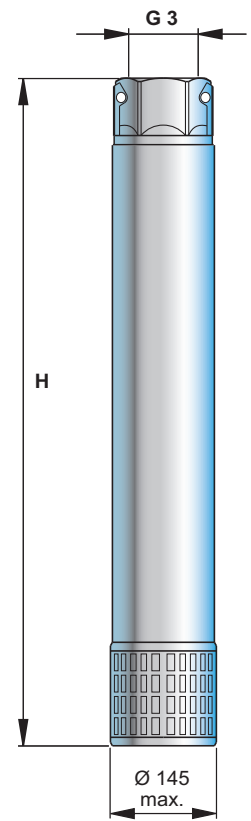
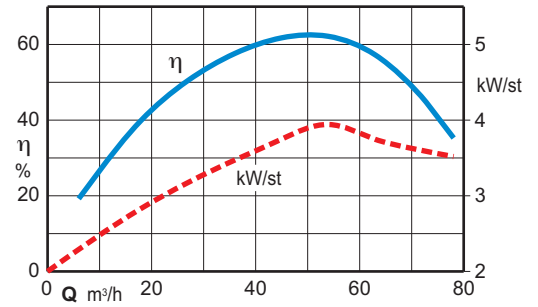
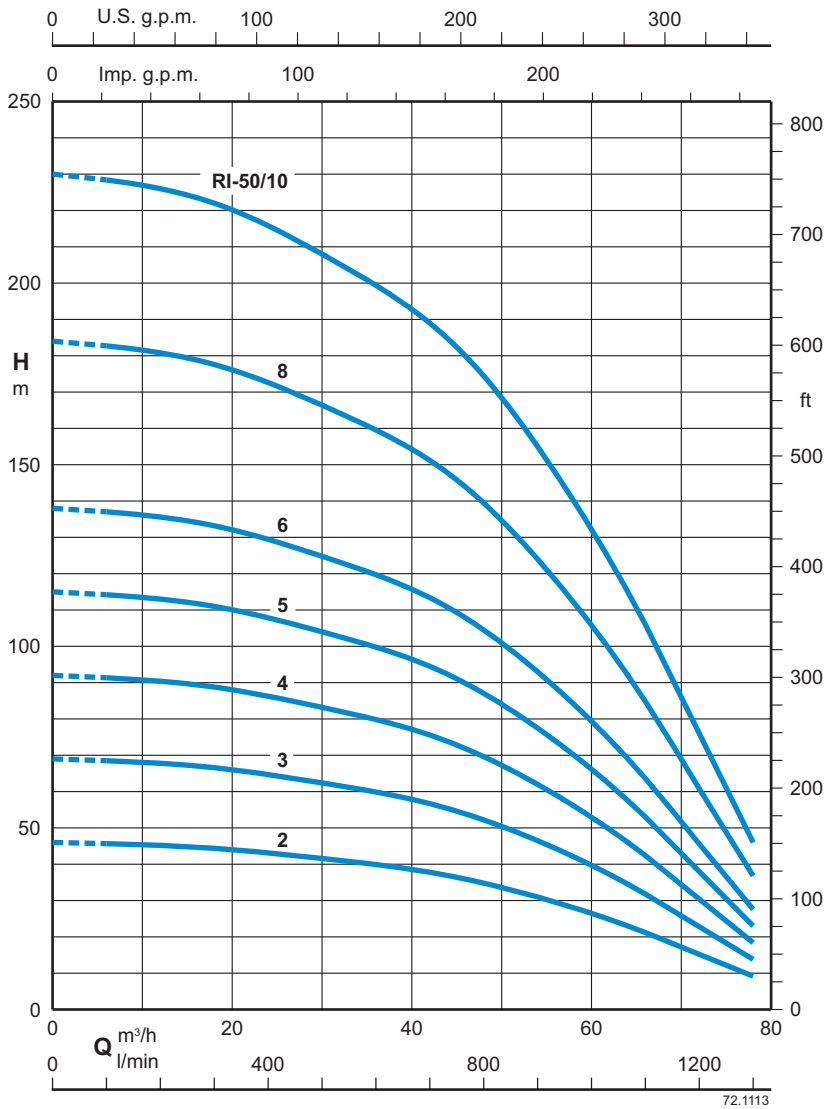

TYPE	MOTOR		Q m³/h l/min	DELIVERY													H mm	kg
	kW	HP		0	12	24	30	36	42	48	54	60	66	72	78			
RI-50/2	7,5	10	H m HEAD	46	45	42	41	40	37	34	30	26	20	15	9	495	17	
RI-50/3	11	15		69	67	64	62	59	56	51	46	39	31	22	13	605	20	
RI-50/4	15	20		93	88	84	82	78	73	68	61	51	40	30	18	715	22	
RI-50/5	18,5	25		116	112	106	103	98	93	86	77	65	51	38	23	825	24	
RI-50/6	22	30		139	135	129	122	118	113	104	93	79	63	45	27	930	26	
RI-50/8	30	40		185	181	171	166	158	149	137	123	105	84	60	36	1150	31	
RI-50/10	37	50		232	226	216	208	198	189	173	155	132	106	76	46	1370	36,5	

The encumbered dimensions and weight are indicative.

RI-14/19/25

Drawing for dismantling and assembly

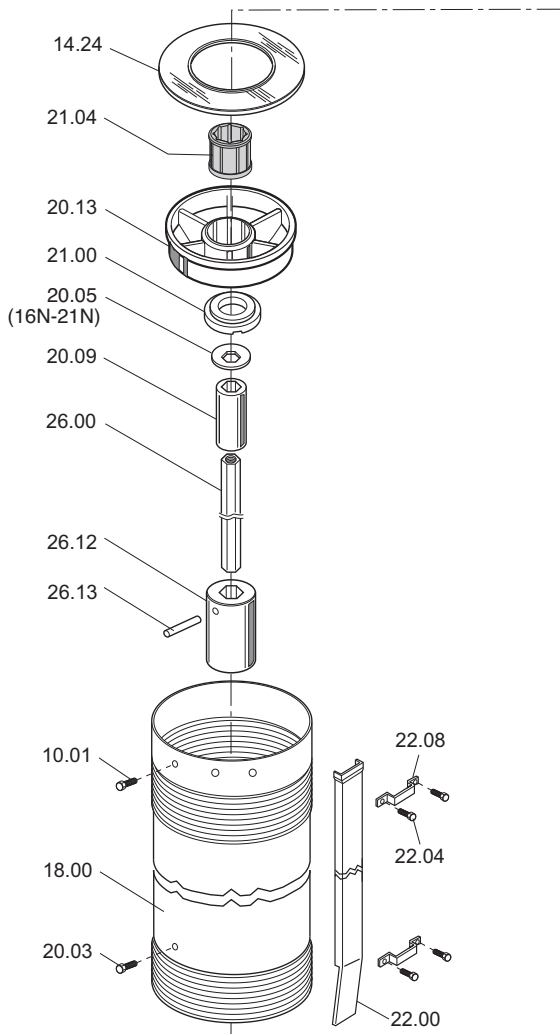

VERSIONI CON MOTORE 4"
4" MOTOR TYPE
VERSION AVEC MOTEUR 4"
PARA MOTOR 4"

VERSIONI CON MOTORE 6"
6" MOTOR TYPE
VERSION AVEC MOTEUR 6"
PARA MOTOR 6"

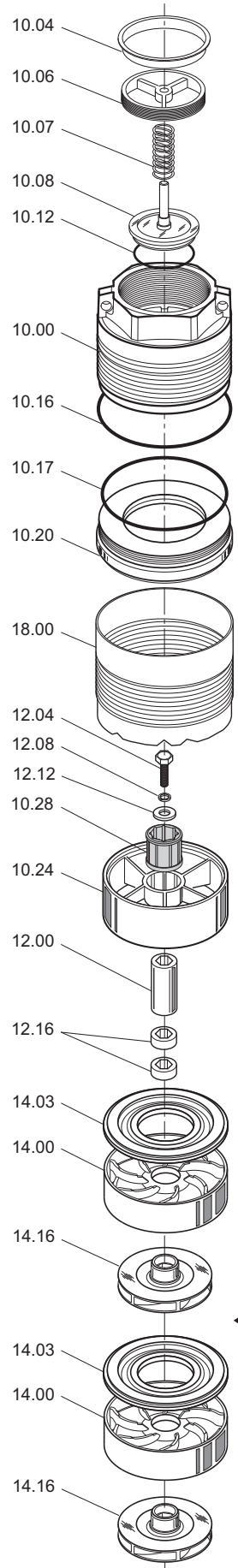
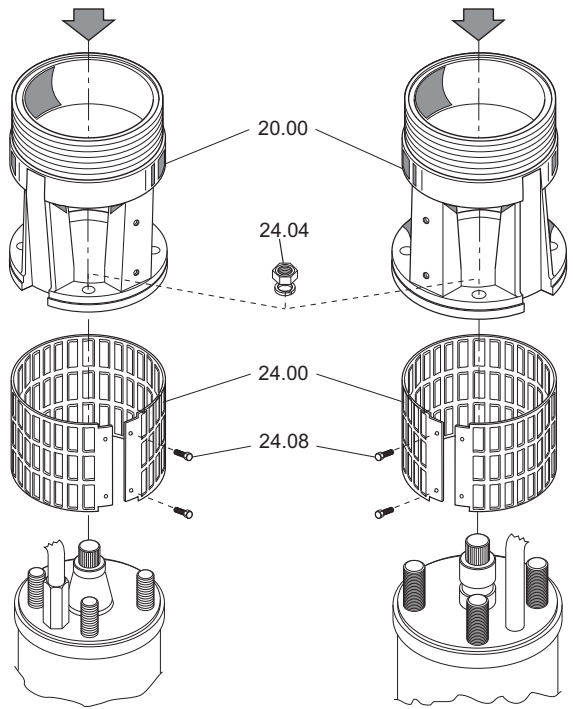

MODELLI CON INTERSTADIO
MODELS WITH INTERMEDIARY BUSH BRACKET
MODELES AVEC PALIER INTERMEDIAIRE
MODELOS CON SOPORTE INTERMEDIO

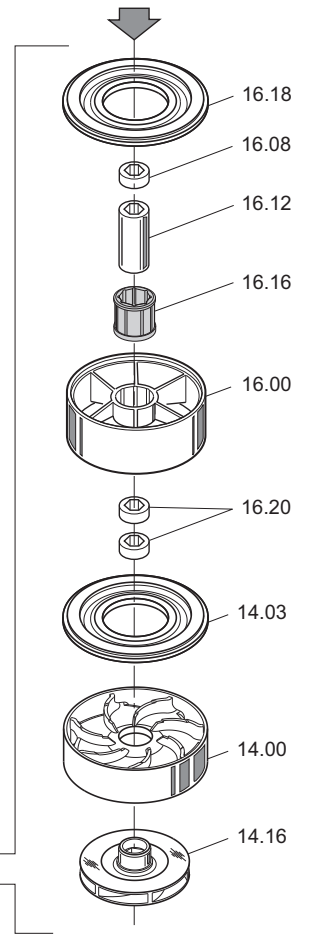

RI-35/40/50

Drawing for dismantling and assembly

